



4 Elizabeth Crescent SOUTH BUNBURY, WA



4



2



2

ELITE LOCATION

Behind this exclusive facade lies a beautiful, timeless family home that we have the pleasure to present to the market. It is a rare opportunity when a home of this calibre comes to the market and for this reason it is a must-see for the discerning buyer. Located just moments from the glorious Back Beach, with elevated views over South Bunbury and the hills beyond, this irreplaceable 847m2 block with an extremely well-planned home is worth your close attention. With multiple formal and informal living spaces, this property will fulfil the desires of any family at any stage of life.

This is an altogether incredible property that must be seen in person to be fully appreciated. To secure a private viewing or for more information please call Exclusive Agent, Tim Cooper, today.

Other Features Include:

4 bedroom, 2 bathroom home

Door leading through to the kitchen from the living/ dining perfect for when you host din

For more details please visit :

<https://www.summitbunbury.com.au/4734132>

Price:

OFFERS INVITED



Tim Cooper

0437 068 028

Basement

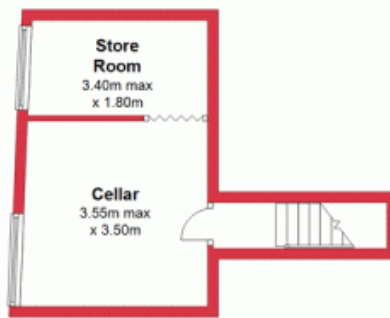

Ground Floor

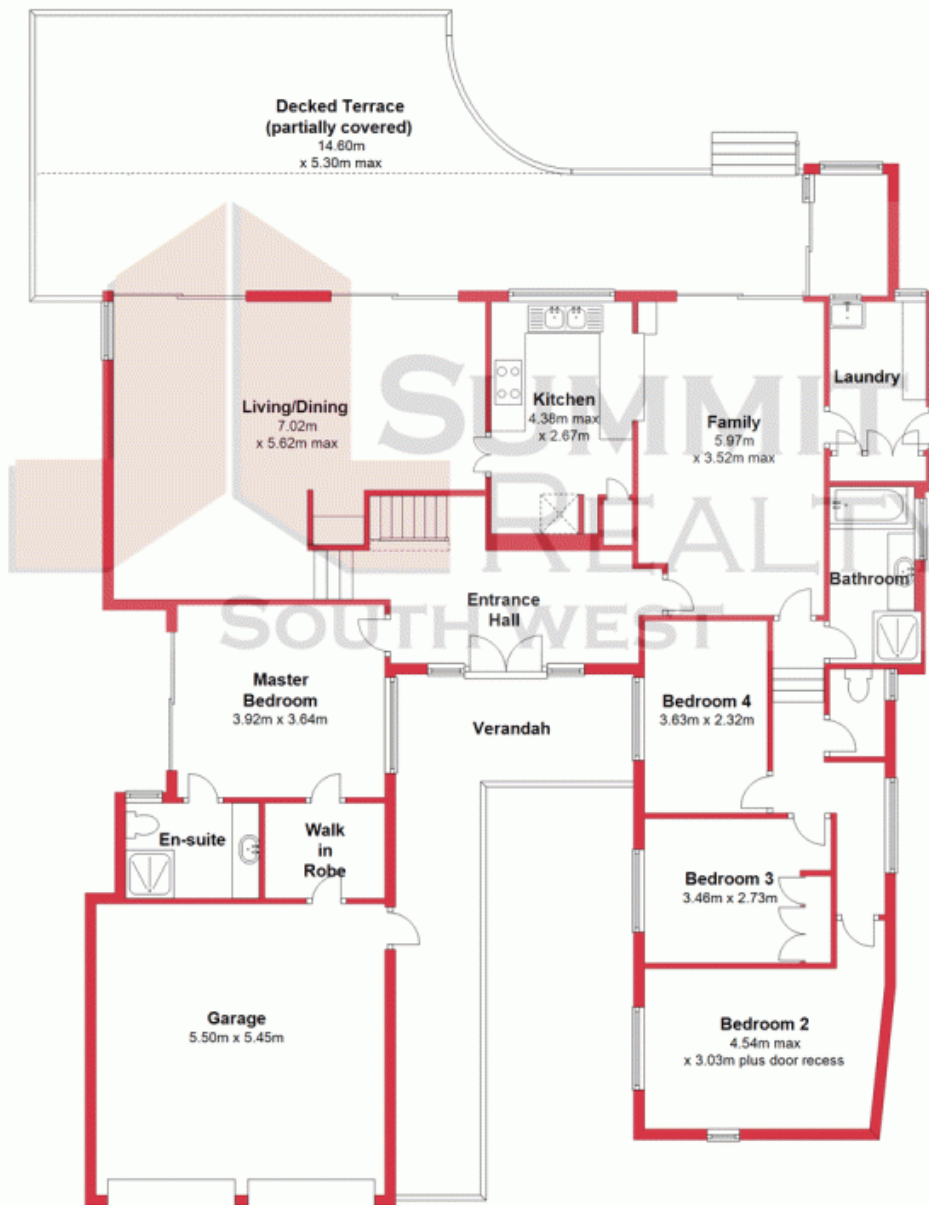

This plan has been prepared for marketing purposes only. Whilst every care is taken in the production of this plan, measurements, angles and positioning of doors/windows may not be accurate. Interested parties are strongly advised to undertake their own checks when establishing the suitability for furniture etc. Not To Scale.

Plan produced using PlanUp.

4 Elizabeth Crescent

4 Elizabeth Cres, South Bunbury,
SOUTH BUNBURY, WA

