



17 Bevan Loop Roelands, WA

 4
  2
  2

Country feel city convenience.

Locals already know the benefits of the beautiful estate of Meadow Landing.

Only a few minutes drive to the Treendale shopping centre and all the convenience of modern life. This fantastic four bedroom home is nestled on a generous 4753m2 block --with a real "getaway from it all" feel.

The well established and cared for gardens are a real treat and all the work has been done here.

This high-quality home boasts lots of high end- features including :

Ducted Air Conditioning
Blackbutt flooring

For more details please visit :
<https://www.summitbunbury.com.au/4835549>

Price: Offers over \$669,000

Council Rates: \$1,948.52/year (approx)

Water Rates: \$257.90/year (approx)



Lorraine Grassie



Adrian Triplett

0419 971 888

Ground Floor

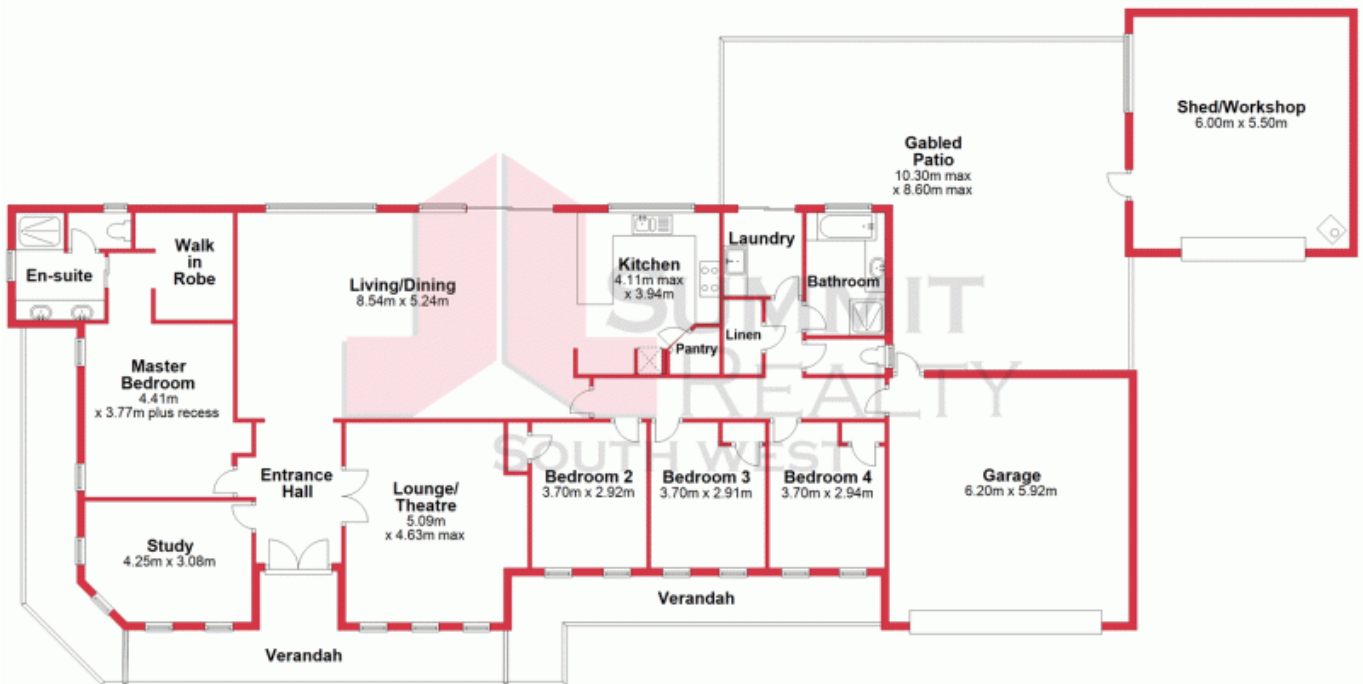

This plan has been prepared for marketing purposes only. Whilst every care is taken in the production of this plan, measurements, angles and positioning of doors/windows may not be accurate. Interested parties are strongly advised to undertake their own checks when establishing the suitability for furniture etc. Not To Scale. Plan produced using PlanUp.

17 Bevan Loop, Roelands

17 Bevan Loop

Roelands, WA

