



62/2 Wattle Street Bunbury, WA

 2
  1
  1

### A VILLA WITH A VIEW!!

Entry off Upper Esplanade Villa 62, Wattle Hill Lifestyle Village has just become available. This immaculate Villa is in the top section of Wattle Hill, close to the ocean and has been fully refurbished, including ducted reverse cycleair through out, giving this home a brand-new feel..

This Villa features Cathedral ceilings to the living area, quality light fittings, a brand-new kitchen and a lovely outlook across the ranges from the family room. Out the front is a fantastic gazebo/sitting area and gorgeous lawns and flowered gardens.

The laundry has a walk-in linen press, second toilet and shoppers access from the large lock up garage, plus a rear door to the paved yard and clothes line. For outside entertaining, there is a large paved alfresco under the main roof, again, overlooking the ranges to t

For more details please visit :  
<https://www.summitbunbury.com.au/4843539>

Price: \$210000



**Lorraine Grassie**

## Ground Floor

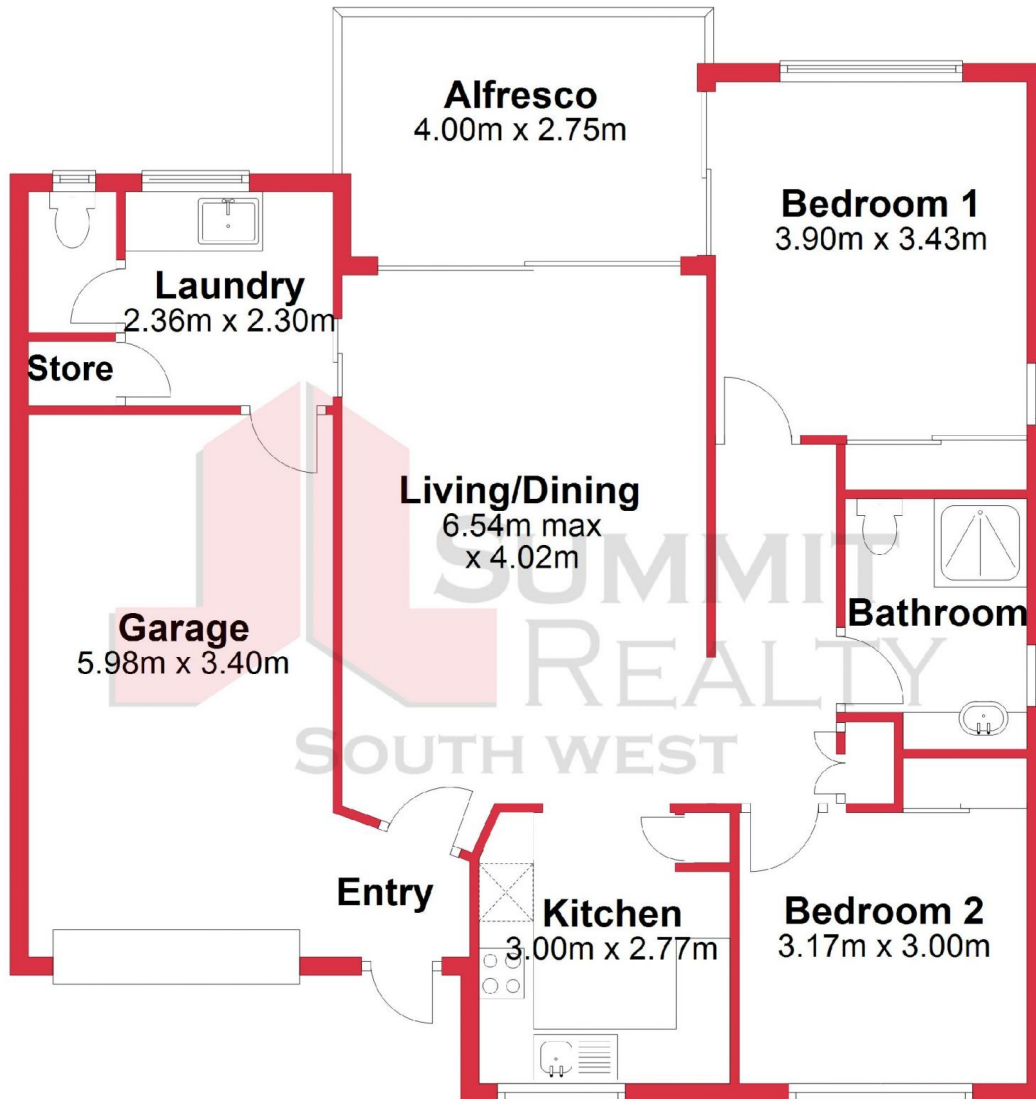

This plan has been prepared for marketing purposes only. Whilst every care is taken in the production of this plan, measurements, angles and positioning of doors/windows may not be accurate. Interested parties are strongly advised to undertake their own checks when establishing the suitability for furniture etc. Not To Scale.

Plan produced using PlanUp.

## 62/2 Wattle St, Bunbury

62/2 Wattle Street

Bunbury, WA

