

11 Prinsep Crescent Collie, WA



4



1



1

BUDGET BUYING

This property is definitely worth a personal inspection being a spacious budget conscious priced home to suit a growing family quietly nestled on the edge of town opposite a spacious well designed public park suitable for all family occasions and for the golf conscious golfer only a short walk to the popular Collie golf course.

The home offers 4 spacious bedrooms fully carpeted and high ceilings, a large lounge room with reverse cycle air conditioner and free standing log fire and electric cooking to the kitchen/ dining area. A activity room or storage area sits opposite a large laundry, separate bathroom and separate toilet.

Price: \$145,000

Council Rates: \$1,345.00/year (approx)

Water Rates: \$1,353.73/year (approx)



Lorraine Grassie

For more details please visit :

<https://www.summitbunbury.com.au/4878503>

Ground Floor

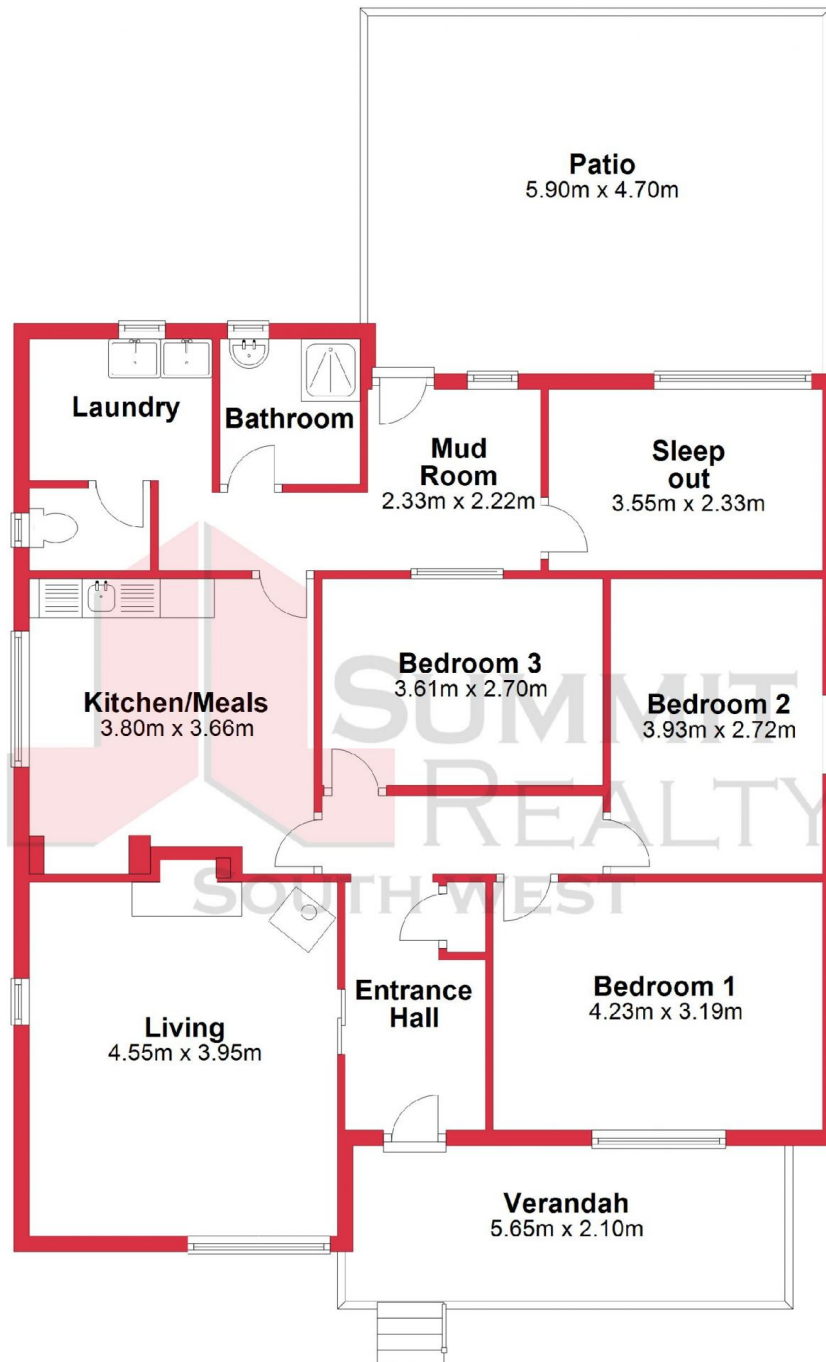

This plan has been prepared for marketing purposes only. Whilst every care is taken in the production of this plan, measurements, angles and positioning of doors/windows may not be accurate. Interested parties are strongly advised to undertake their own checks when establishing the suitability for furniture etc. Not To Scale.

Plan produced using PlanUp.

11 Prinsep Crescent, Collie

11 Prinsep Crescent

Collie, WA

