



30 Matilda Avenue Australind, WA

 4
  2
  2

A terrific start awaits you

With a focus on comfort and ease of living, this great 4-bedroom 2-bathroom home is the ideal starter in the property market.

Featuring an open plan family and dining area together with a well-appointed kitchen, you will be impressed with the space this home provides.

Situated on a large 815m2 corner block with side access to the yard and double carport with roller door, this great property won't last long.

Additional features:

- 4 great sized bedrooms
- 2 bathrooms
- Wood fireplace

For more details please visit :

<https://www.summitbunbury.com.au/5060668>

Price: Offers over \$289,000

Council Rates: \$1,704.09/year (approx)

Water Rates: \$257.90/year (approx)



Adrian Triplett

0419 971 888

Ground Floor

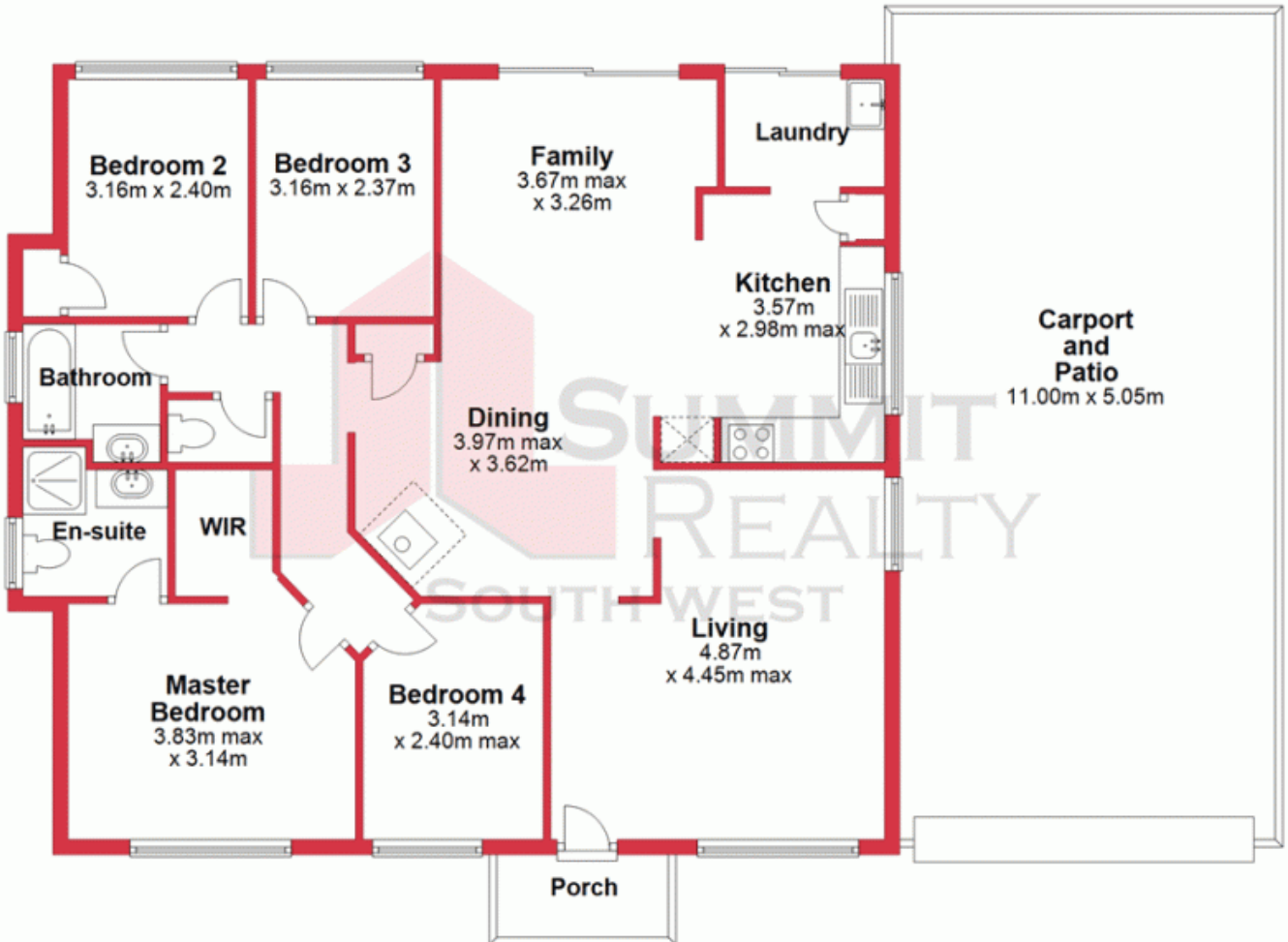

This plan has been prepared for marketing purposes only. Whilst every care is taken in the production of this plan, measurements, angles and positioning of doors/windows may not be accurate. Interested parties are strongly advised to undertake their own checks when establishing the suitability for furniture etc. Not To Scale.
Plan produced using PlanUp.

30 Matilda Ave, Australind

30 Matilda Avenue

Australind, WA

