



17 Priory Road Australind, WA

4 bedrooms, 2 bathrooms, 2 cars

Great family home in Galway Green

This great home offers the perfect start for a growing family. With 4 good sized bedrooms plus a study together with a separate lounge, meals, family and big games room, this home really has it all.

An open plan kitchen with island bench and loads of storage, with French wooden doors opening up to the outdoors, the home has plenty of indoor/outdoor dining options.

The master bedroom features his and hers walk in robes and large ensuite plus a parent's retreat, ideal for a bit of peace and quiet.

Don't wait, book a viewing today.

Price: \$449,000-\$479,000

Council Rates: \$2,246.72/year (approx)

Water Rates: \$1,301.27/year (approx)



Lorraine Grassie



Adrian Triplett

0419 971 888

For more details please visit :
<https://www.summitbunbury.com.au/5189563>

NOTE:
SMOKE DETECTORS TO BE
300mm FROM CORNICE/WALL

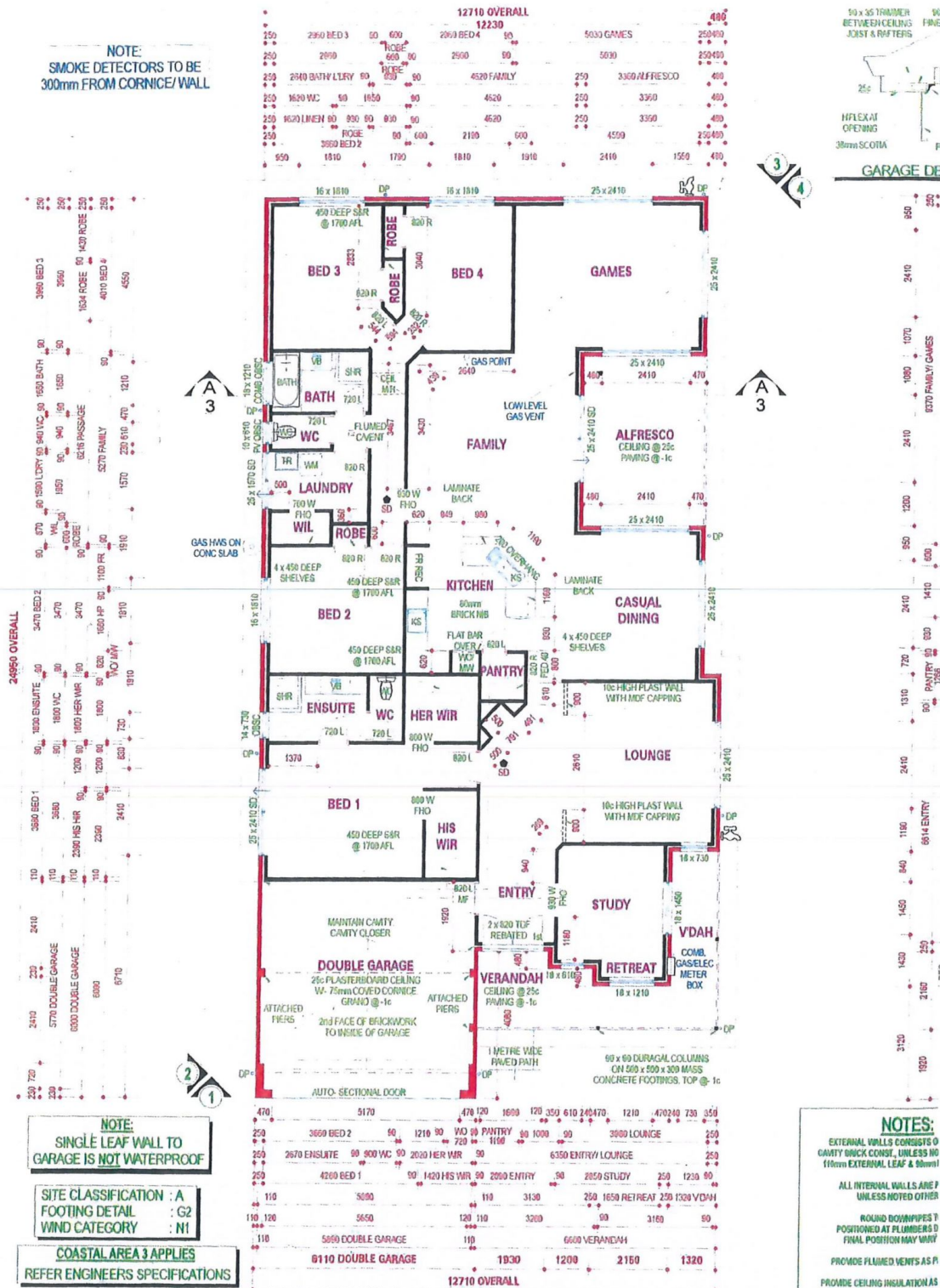

<p>SCOTT PARK HOMES SOUTH WEST Real Homes for Real People 20 Spencer Street BUNBURY WA 6230 TELEPHONE (08) 9791 8008 FACSIMILE (08) 9791 9989</p>	<p>THIS IS ONE OF THE DRAWINGS REFERRED TO IN THE CONTRACT</p> <p>DATED: _____</p> <p>OWNER: _____ WITNESS: _____</p> <p>OWNER: _____ WITNESS: _____</p> <p>BUILDER: _____ WITNESS: _____</p>	<p>HOUSE NAME ARGYLE 231 SB (SW)</p> <p>AREAS UPDATED 11/12/2005 DSJ</p> <p>House Area = 230.64m² Garage Area = 36.45m² Verandah Area = 15.26m² Alfresco Area = 15.76m² TOTAL AREA = 298.11m²</p> <p>Roof Area = 328.22m² Gutter Length = 78.2m House Perim. = 75.8m</p>	<p>DRAWING NAME FLOOR PLAN</p> <p>VARIATIONS: Revision Variations Date Cn By</p>	<p>SHEET No. 2 OF 5 REVISION A</p> <p>CLIENT NAME FITZGERALD SITE ADDRESS LOT 350 PRIORY R AUSTRALIND COUNCIL SHIRE OF HARVEY</p> <p>Drawn By DSJ Date Drawn 20/12/05 Scale 1:1</p>
--	---	---	---	---

17 Priory Road

Australind, WA

