



38 Constellation Drive Australind, WA



Your new life starts here

Centrally located in the heart of Treendale, this stunning 3-bedroom 2-bathroom home is the perfect first home. Presenting like new, this home offers spacious open plan living and a large patio and alfresco area, perfect for entertaining all year round.

The well-appointed kitchen features soft close drawers and cupboards while overlooking the dining area and family lounge room. A theatre room with integrated speakers is perfect for family movie nights.

A generously sized master bedroom features large walk in robe and ensuite together with two additional minor bedrooms each with built in robes.

Price: Offers over \$379,000

Council Rates: \$2,205.33/year (approx)

Water Rates: \$1,244.89/year (approx)



Adrian Triplett

0419 971 888

For more details please visit :
<https://www.summitbunbury.com.au/5249371>

Ground Floor

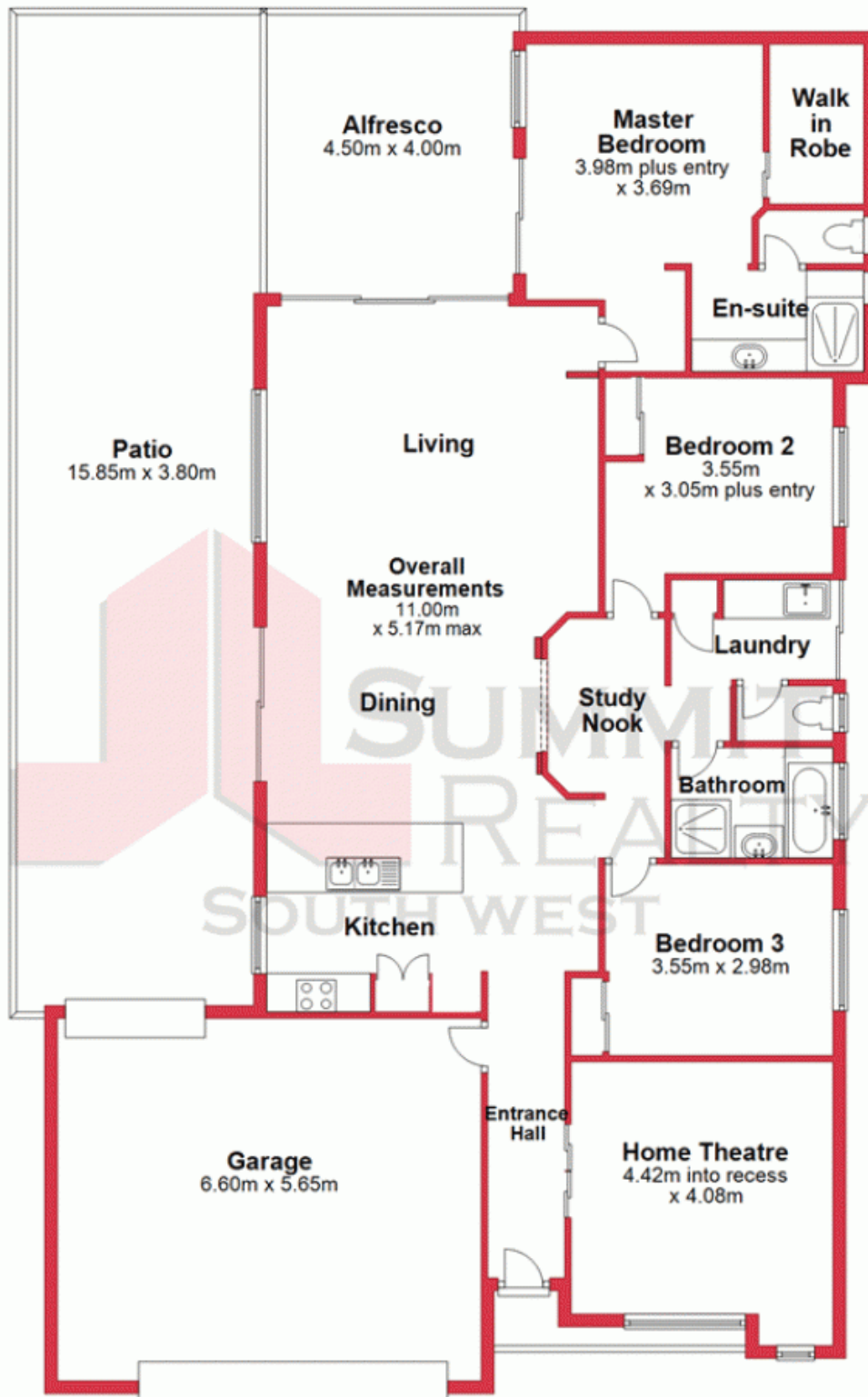

This plan has been prepared for marketing purposes only. Whilst every care is taken in the production of this plan, measurements, angles and positioning of doors/windows may not be accurate. Interested parties are strongly advised to undertake their own checks when establishing the suitability for furniture etc. Not To Scale.
Plan produced using PlanUp.

38 Constellation Drive, Australind

38 Constellation Drive

Australind, WA

