



9 Little Place Leschenault, WA

 4
  2
  2

Lifestyle location

What's not to love about this stunning Leschenault home. Situated on an elevated 4010m2 block, this great property is surrounded by lush gardens and beautifully manicured lawns. Relax under the patio and enjoy the spoils of nature.

Featuring a spacious kitchen with loads of storage and bench space together with a formal dining room and separate formal lounge area.

A large master bedroom includes ensuite with double vanities and built in robe. With 3 additional bedrooms plus separate study, this home is ideal for a growing family or those seeking plenty of space.

Drive up to the powered workshop with room to park a boat, caravan or work vehicle.

Price: \$630,000

Council Rates: \$2,082.15/year (approx)

Water Rates: \$257.90/year (approx)



Adrian Triplett

0419 971 888

For more details please visit :
<https://www.summitbunbury.com.au/5259912>

Ground Floor

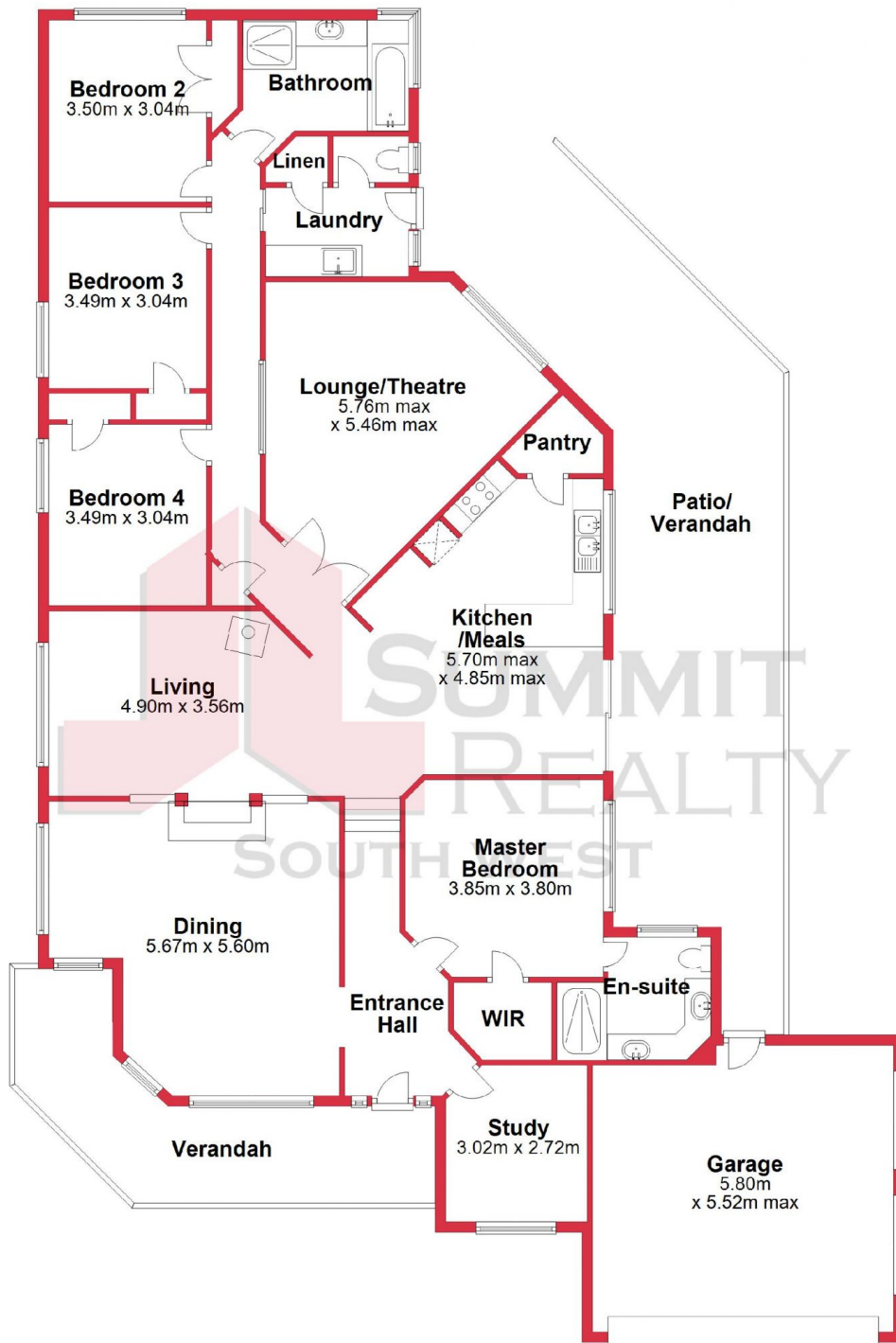

This plan has been prepared for marketing purposes only. Whilst every care is taken in the production of this plan, measurements, angles and positioning of doors/windows may not be accurate. Interested parties are strongly advised to undertake their own checks when establishing the suitability for furniture etc. Not To Scale.
Plan produced using PlanUp.

9 Little Place, Leschenault

9 Little Place

Leschenault, WA

