



15 Nunnagine Circle Roelands, WA

3  1  2 

## Country charm so close to the city Book a viewing today

With views of Roelands hills and surrounded by immaculately landscaped gardens and lawns, this charming mix of modern and country style brings peace and tranquillity whilst being so close to Australind and Eaton.

Stunning timber flooring throughout the main living areas gives a real sense of warmth and grandeur to the home. Fall in love with the beautiful country kitchen featuring wood fireplace and loads of room for a big family dining table together with a large pantry and heaps of storage space.

Peaceful nights and quiet days spent in the country surrounded by chooks, fruit trees and veggie gardens.

This great property is a dream come true, contact Team Miller Triplett for a viewing today

For more details please visit :

<https://www.summitbunbury.com.au/5264249>

**Price:** Contact Agent

**Council Rates:** \$1,926.48/year (approx)

**Water Rates:** \$257.90/year (approx)



**Lorraine Grassie**



**Adrian Triplett**

0419 971 888

## Ground Floor

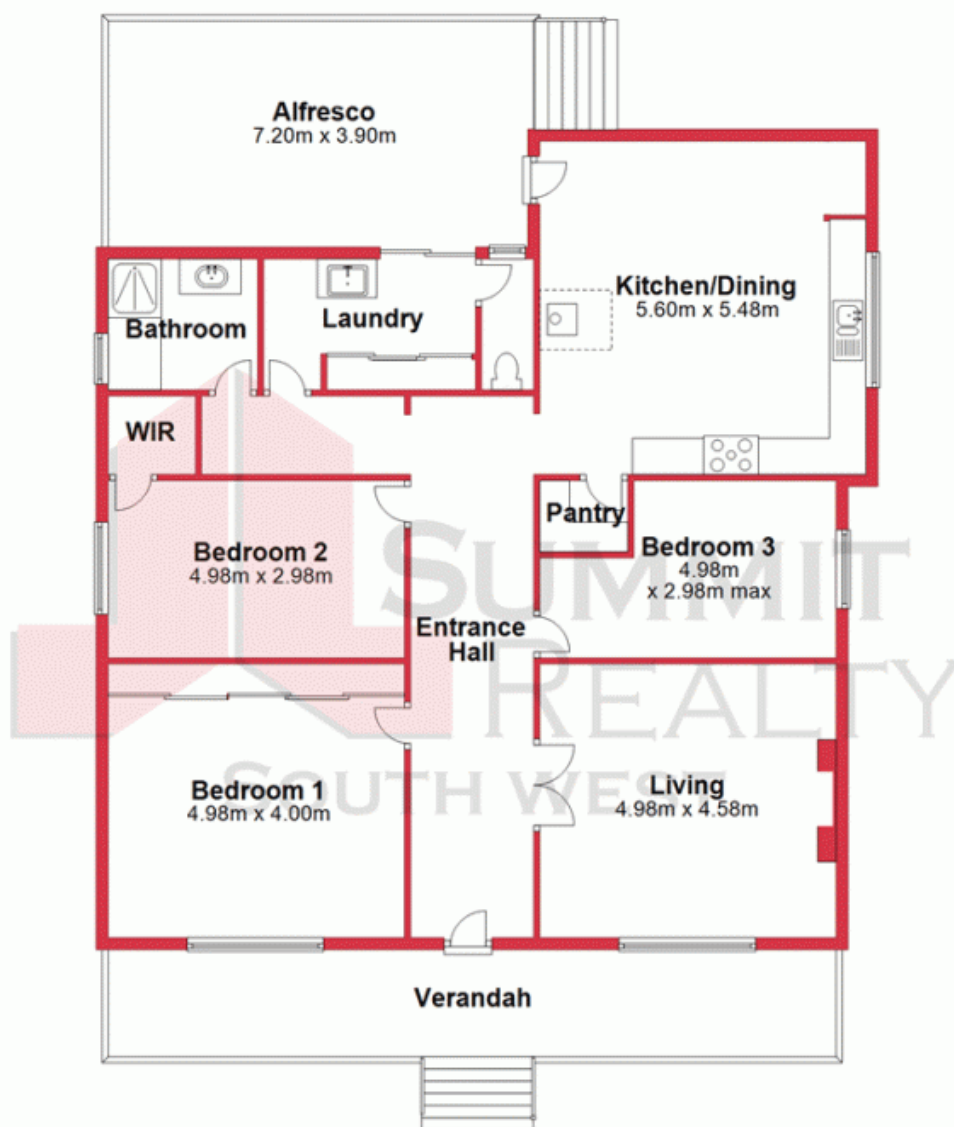

This plan has been prepared for marketing purposes only. Whilst every care is taken in the production of this plan, measurements, angles and positioning of doors/windows may not be accurate. Interested parties are strongly advised to undertake their own checks when establishing the suitability for furniture etc. Not To Scale.  
Plan produced using PlanUp.

**15 Nunnagine Circle, Roelands**

15 Nunnagine Circle

Roelands, WA

