



14 Picton Crescent Bunbury, WA

 4
  2
  2

## A NEW YEAR WELCOMES A NEW FAMILY

Property features you'll love:

White fencing surrounding the front of the home with a lovely veranda with plenty of room for a table and chairs

Lounge room includes a fire place and double door entry into the spacious formal dining room which also boasts a wood fire

Entertain your guests with a large games room or man cave which features a pot belly fire and is carpeted

Kitchen features plenty of storage space, dishwasher, SMEG oven, walk in pantry and leads into another dining area

Master retreat features double door entry onto the veranda, walk in robe and modernised bathroom with a toilet and shower

Laundry and main bathroom are practical and spacious

6 solar panels

It's all about LOCATION - this stunning home is just walking distance from all amenities i

For more details please visit :

<https://www.summitbunbury.com.au/5290914>

**Price:** \$750000

**Council Rates:** \$2,281.89/year (approx)

**Water Rates:** \$251.89/year (approx)



**Tim Cooper**

0437 068 028

## Ground Floor

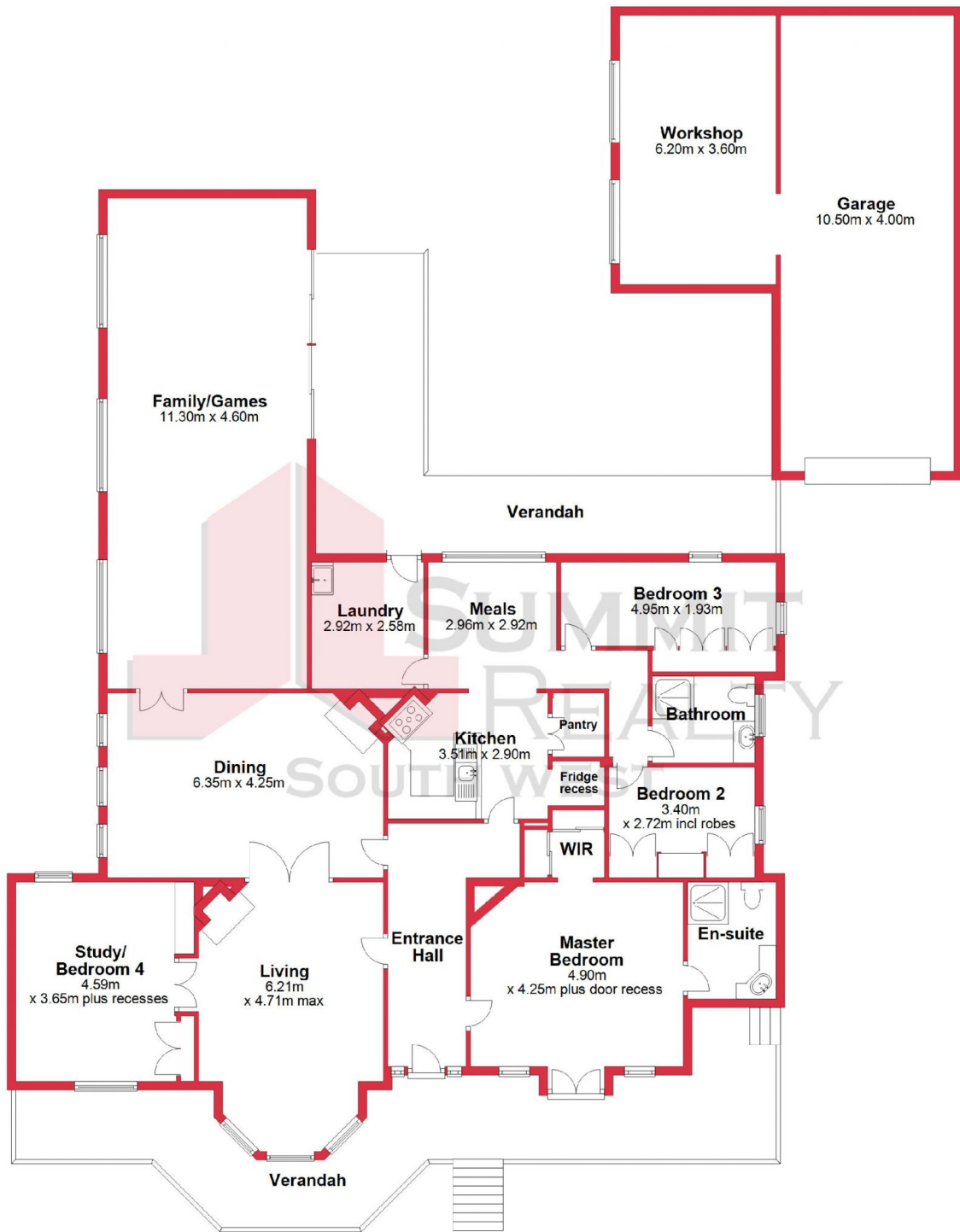

This plan has been prepared for marketing purposes only. Whilst every care is taken in the production of this plan, measurements, angles and positioning of doors/windows may not be accurate. Interested parties are strongly advised to undertake their own checks when establishing the suitability for furniture etc. Not To Scale.  
Plan produced using PlanUp.

**14 Picton Crescent, Bunbury**

**14 Picton Crescent**

**Bunbury, WA**

