



162 Lucy Victoria Avenue Australind, WA

4 Bedrooms 2 Bathrooms 2 Car Spaces

## THE PERFECT FAMILY HOME

Located in the family orientated and sought-after area of Clifton Park sits this inviting 4 Bedroom, 2 Bathroom residence on a 748m<sup>2</sup> block.

Immaculately presented inside and out and perfectly configured for relaxed family living, it offers light filled interiors, spacious living, and needing nothing to be spent for many years to come.

Just a short stroll to the estuary where you can enjoy an array of activity such as fishing, crabbing and much more why would you want to live anywhere else!

- Spacious Master Bedroom with large walk in wardrobe and Ensuite.
- Air-conditioning in main living area

For more details please visit :  
<https://www.summitbunbury.com.au/5302598>

**Price:** Offers Over \$439,000

**Council Rates:** \$1,817.72/year (approx)

**Water Rates:** \$1,160.29/year (approx)



**Lorraine Grassie**



**Adrian Triplett**

0419 971 888

## Ground Floor

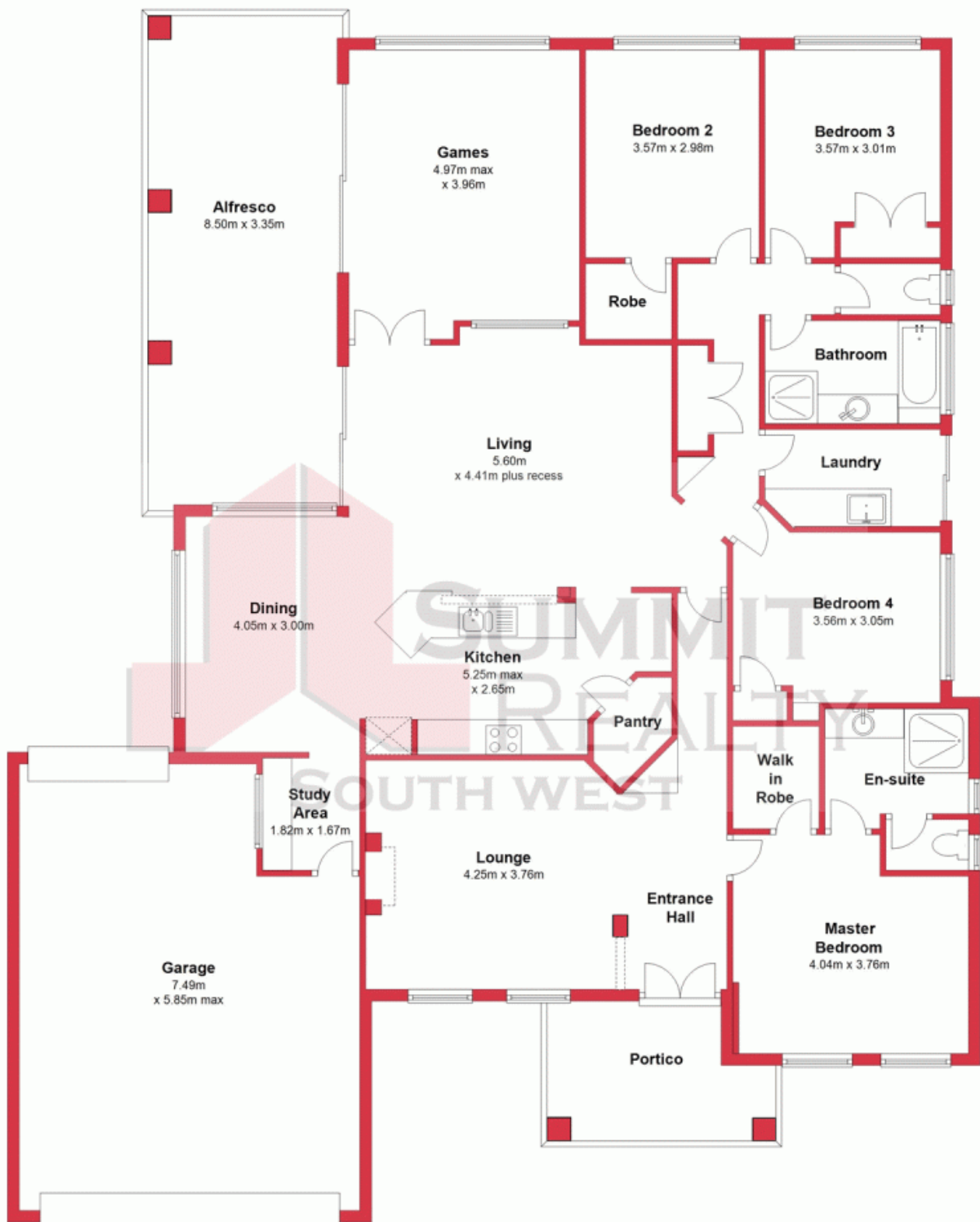

This plan has been prepared for marketing purposes only. Whilst every care is taken in the production of this plan, measurements, angles and positioning of doors/windows may not be accurate. Interested parties are strongly advised to undertake their own checks when establishing the suitability for furniture etc. Not To Scale.  
Plan produced using PlanUp.

162 Lucy Victoria Avenue

162 Lucy Victoria Ave, Australind, WA

