



2 Regal Court South Bunbury, WA



Wake up to amazing views of Bunbury's iconic wetlands

With views of the Bunbury wildlife reserve and just moments from the iconic back beach, you will find this impressive low maintenance home. With 3 bedrooms and 2 bathrooms spread out over two levels, this great property feels fresh and bright.

A stunning kitchen features quality fixtures with loads of drawers, bench space and breakfast bar. The family room flows through to the impressive outdoor alfresco zone, complete with timber ceiling and flooring and roller blinds, perfect for use all year round.

Price: From \$510,000

Council Rates: \$2,281.89/year (approx)

Water Rates: \$1,169.55/year (approx)



Adrian Triplett

0419 971 888



Tim Cooper

0437 068 028

For more details please visit :

<https://www.summitbunbury.com.au/5369093>

Ground Floor

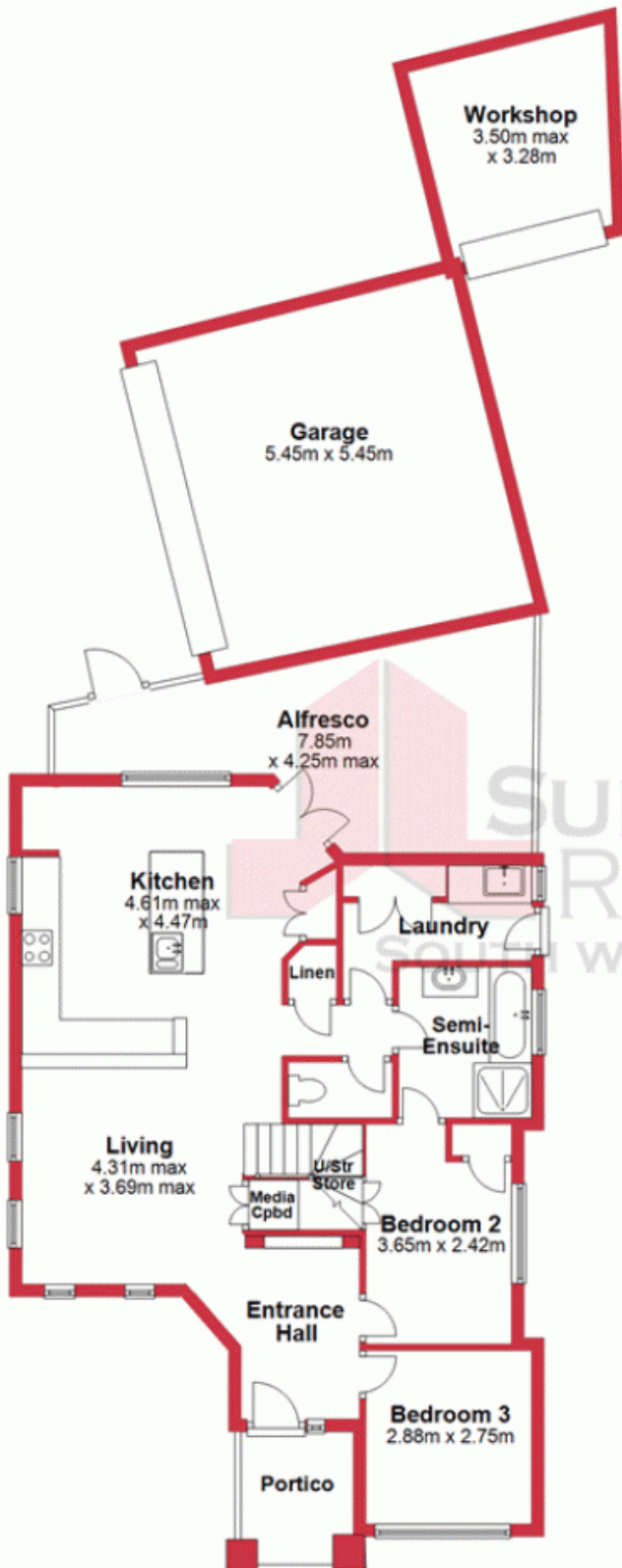

First Floor

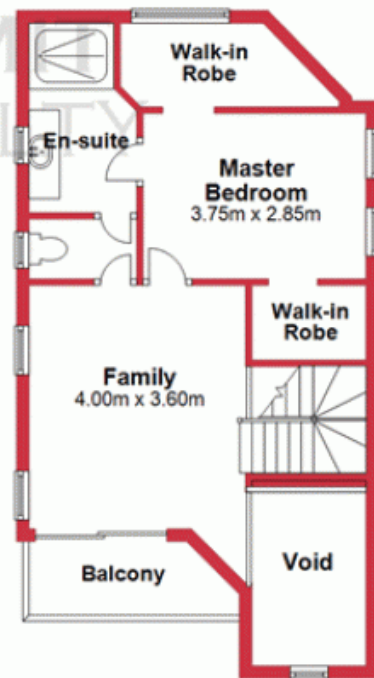

This plan has been prepared for marketing purposes only. Whilst every care is taken in the production of this plan, measurements, angles and positioning of doors/windows may not be accurate. Interested parties are strongly advised to undertake their own checks when establishing the suitability for furniture etc. Not To Scale.
Plan produced using PlanUp.

2 Regal Ct, South Bunbury

2 Regal Court

South Bunbury, WA

