

4 Kabi Court Peppermint Grove Beach, WA



4



2

SEA CHANGE TO PEPPERMINT GROVE BEACH!

Property features you'll love:

Well-presented front lawns and gardens with a double automatic garage with extra height

Large entrance hall leading straight through to the open plan and spacious living and dining area

Extremely functional kitchen with a large island bench and breakfast bar, double sinks, soft closing drawers, essastone bench tops, double fridge recess and quality lighting

Lounge area features wood fire and recessed ceilings

Home theatre is carpeted and also features recessed ceilings

Three secondary bedrooms all have built in robes

LED lighting in the main hub

For more details please visit :

<https://www.summitbunbury.com.au/5397796>

Price: From \$570,000

Council Rates: \$2,100.00/year (approx)



Tim Cooper

0437 068 028

Ground Floor

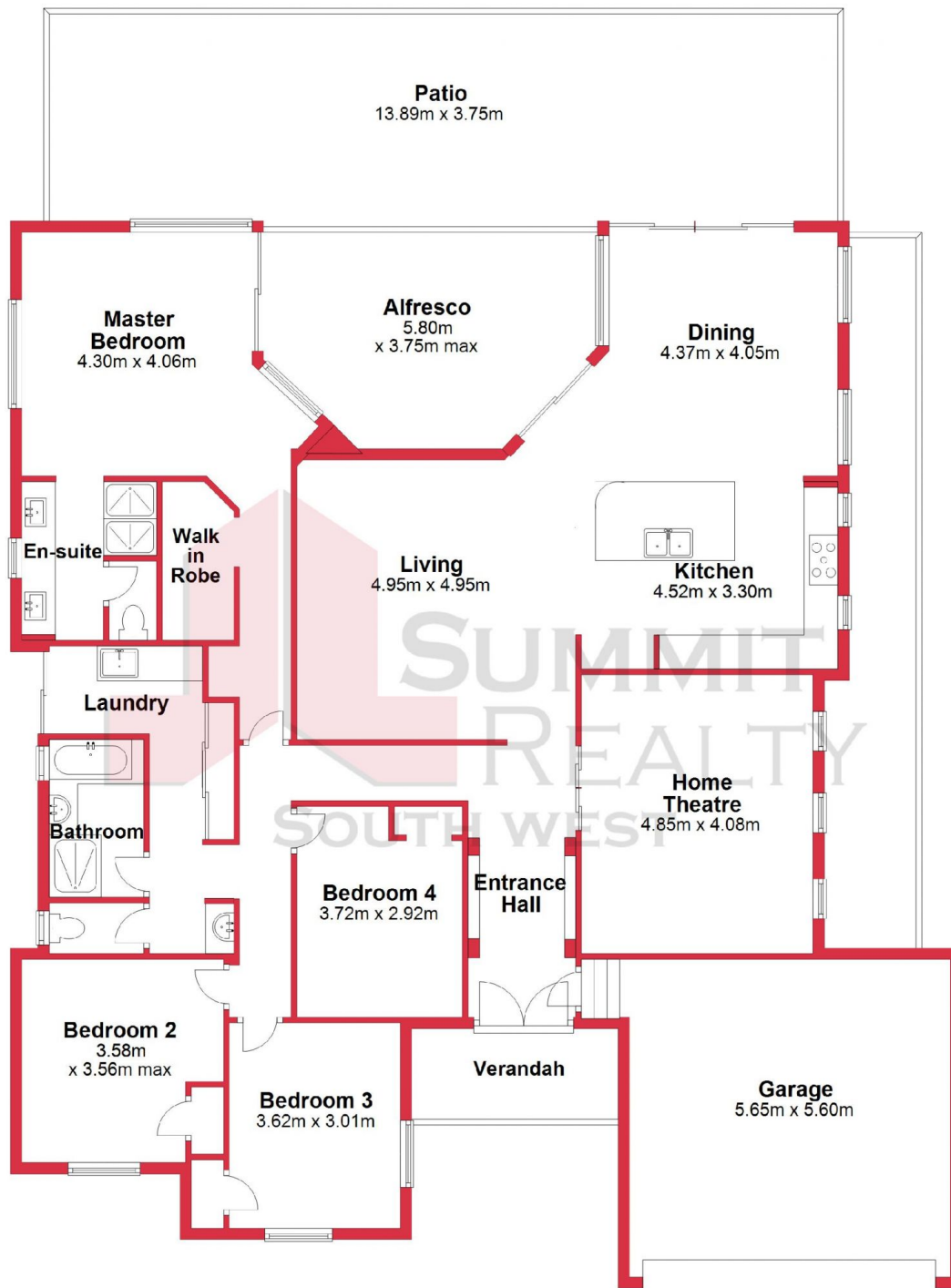

This plan has been prepared for marketing purposes only. Whilst every care is taken in the production of this plan, measurements, angles and positioning of doors/windows may not be accurate. Interested parties are strongly advised to undertake their own checks when establishing the suitability for furniture etc. Not To Scale.
Plan produced using PlanUp.

4 Kabi Ct, Peppermint Grove Beach

4 Kabi Court

Peppermint Grove Beach

