



46 Barton Drive Australind, WA

 4
  2
  2

## QUALITY FAMILY HOME

Come home to this beautifully presented four bedroom, two bathroom home.

Set on a good sized 694m2 block and featuring an open plan interior with large sized rooms and a separate lounge room- this neat and tidy family home provides easy living for you and your family.

The outdoors offers plenty of space for entertaining and lots of room for the kids or pets to play. With side access and plenty of room to store the caravan, boat or any other number of toys!

Built in 2004, this property features:

For more details please visit :  
<https://www.summitbunbury.com.au/5564026>

**Price:** \$339,000

**Council Rates:** \$1,890.83/year (approx)

**Water Rates:** \$1,135.62/year (approx)



**Lorraine Grassie**



**Adrian Triplett**

0419 971 888

## Ground Floor

Approx. 150.0 sq. metres

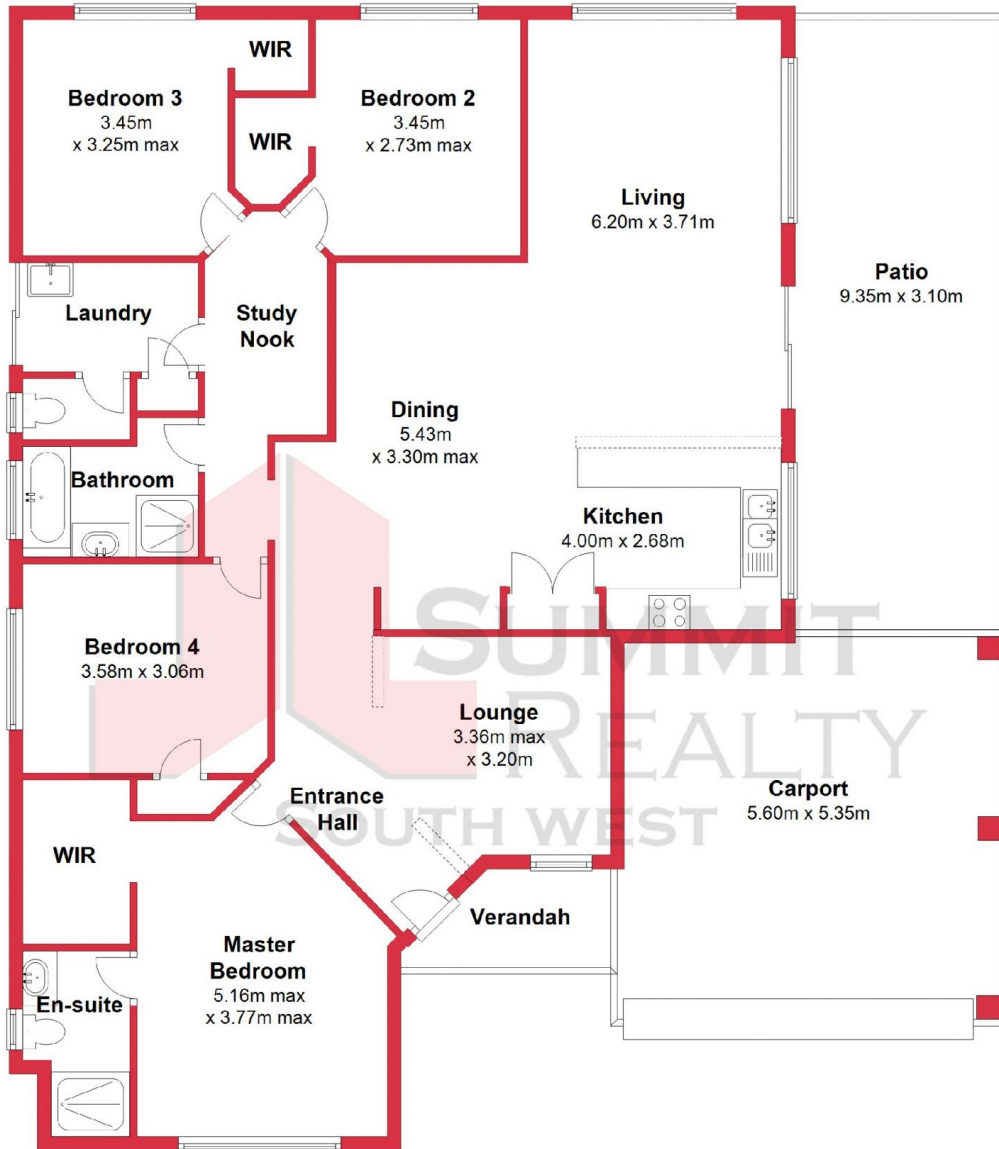

Total area: approx. 150.0 sq. metres

This plan has been prepared for marketing purposes only. Whilst every care is taken in the production of this plan, measurements, angles and positioning of doors/windows may not be accurate. Interested parties are strongly advised to undertake their own checks when establishing the suitability for furniture etc. Not To Scale.

Plan produced using PlanUp.

**46 Barton Drive, Australind**

**46 Barton Drive**

**Australind, WA**

