



127 Dalyellup Boulevard Dalyellup, WA



## The Perfect Balance

Welcome to The Manhattan - 2007 Country Builders' Telethon Home

Overflowing with luxurious, quality finishes this large executive home is something truly special.

This design breaks a few conventional rules- the entertaining "zone" expands with ease-

The combination of a bold Portico tinted, sleek windows and natural feature stonework make a strong streetscape statement.

Park in the wide driveway and know this home can accommodate both a party of people, their vehicles and more toys...

**Price:** \$495000

**Council Rates:** \$2,328.36/year (approx)

**Water Rates:** \$1,056.65/year (approx)



**Lorraine Grassie**

For more details please visit :  
<https://www.summitbunbury.com.au/5778331>

## Ground Floor

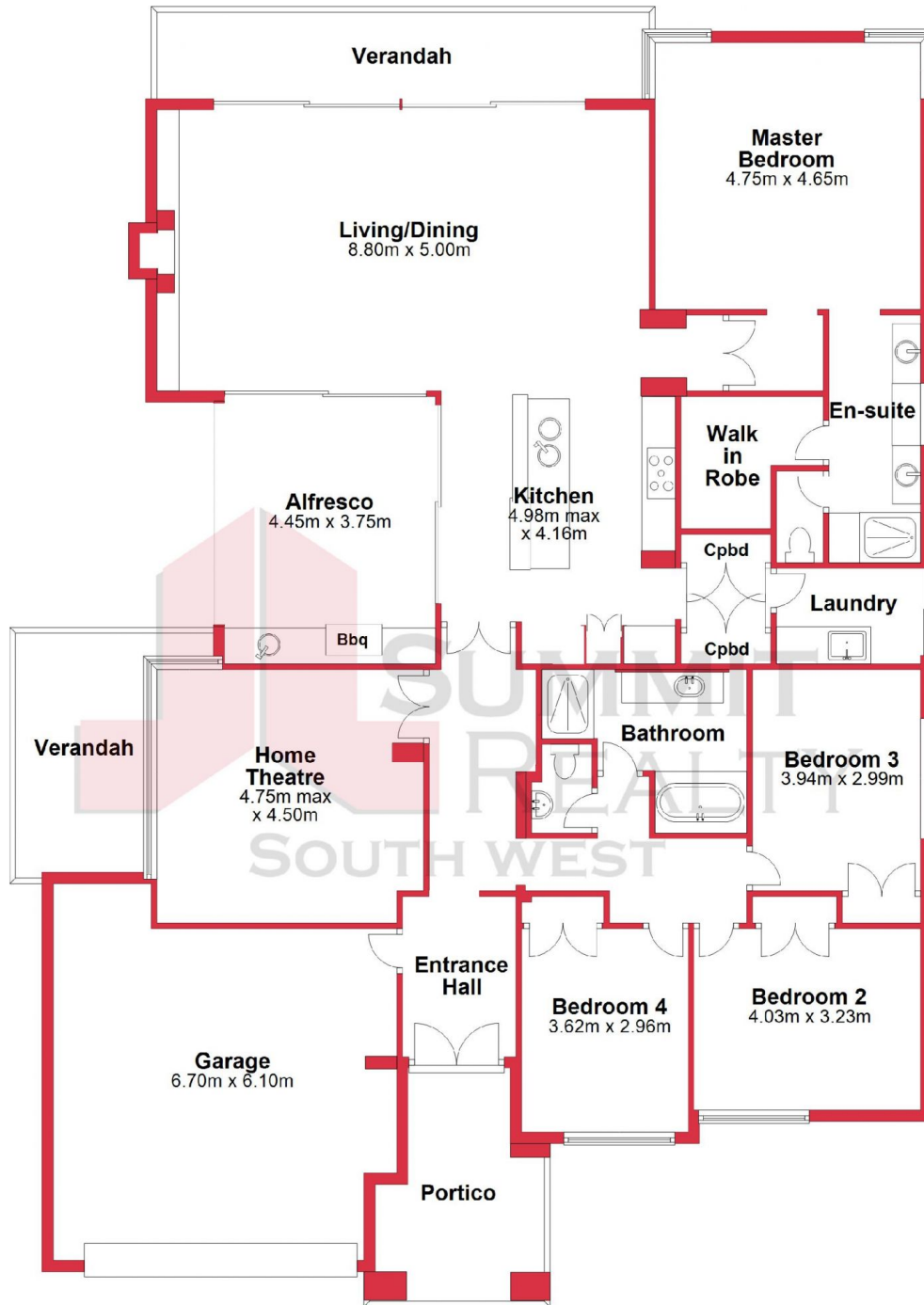

This plan has been prepared for marketing purposes only. Whilst every care is taken in the production of this plan, measurements, angles and positioning of doors/windows may not be accurate. Interested parties are strongly advised to undertake their own checks when establishing the suitability for furniture etc. Not To Scale.

Plan produced using PlanUp.

**127 Dalyellup Blvd, Dalyellup**

127 Dalyellup Boulevard

Dalyellup, WA

