



7 Chidlow Way Roelands, WA

 4
  2
  2

MEADOW LANDING OASIS

Sitting on a large 4006m2 property and surrounded by beautiful native greenery you will enjoy the secluded feel of this country style home. Located in the beautiful estate of Meadow Landing and offering a versatile and spacious interior that will suit a growing family or those seeking space, tranquility and comfort.

Stunning inside and out! From Top quality finishes and appliances to be able to Entertain friends and family outside under the alfresco area. If that's not enough have the ability to get to work in your massive 10x12m 3 phase powered shed.

Built by Summit Homes in 2008, This house has everything that you need, Features include;

For more details please visit :
<https://www.summitbunbury.com.au/5784479>

Price: Offers Over \$689,000

Council Rates: \$3,283.05/year (approx)

Water Rates: \$264.36/year (approx)



Adrian Triplett

0419 971 888

Ground Floor

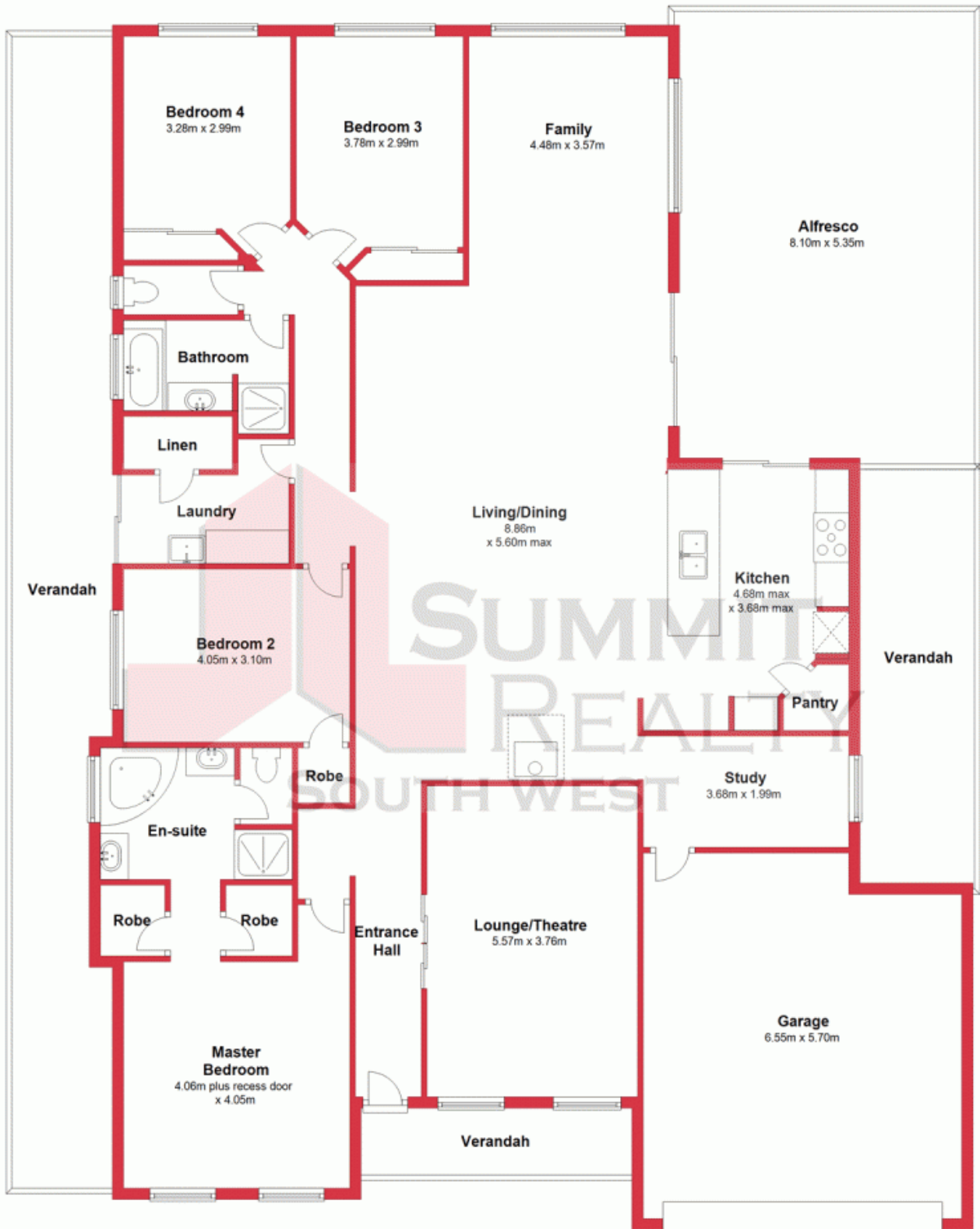

This plan has been prepared for marketing purposes only. Whilst every care is taken in the production of this plan, measurements, angles and positioning of doors/windows may not be accurate. Interested parties are strongly advised to undertake their own checks when establishing the suitability for furniture etc.

Not To Scale.

Plan produced using PlanUp.

7 Chidlow Way

7 Chidlow Way, Roelands
Roelands, WA

