



177 Maidment Parade Dalyellup, WA

 4
  2
  2

Perfectly Positioned

Too hot- Need room to spread out-

Enjoy the sea breeze at home or follow the road to the Dalyellup beach-.and hop, skip and jump right in! Perhaps you prefer to throw in a line-.

Situated off a convenient slip lane, opposite the "Fish" Park, this large family home is surrounded by exciting playgrounds, lawns for a cricket match, space to kick the footy, fly a kite, play on the table tennis table, shoot some hoops at the basketball ring, walk the dogs-.

There are Barbeque facilities to cook up a storm, so you can entertain friends whilst the kids enjoy all there is on offer-.

Flexible in design-the generous central Great Room has space for all the family to be toge

For more details please visit :
<https://www.summitbunbury.com.au/5846941>

Price: \$377000

Water Rates: \$1,092.00/year (approx)



Lorraine Grassie

Ground Floor

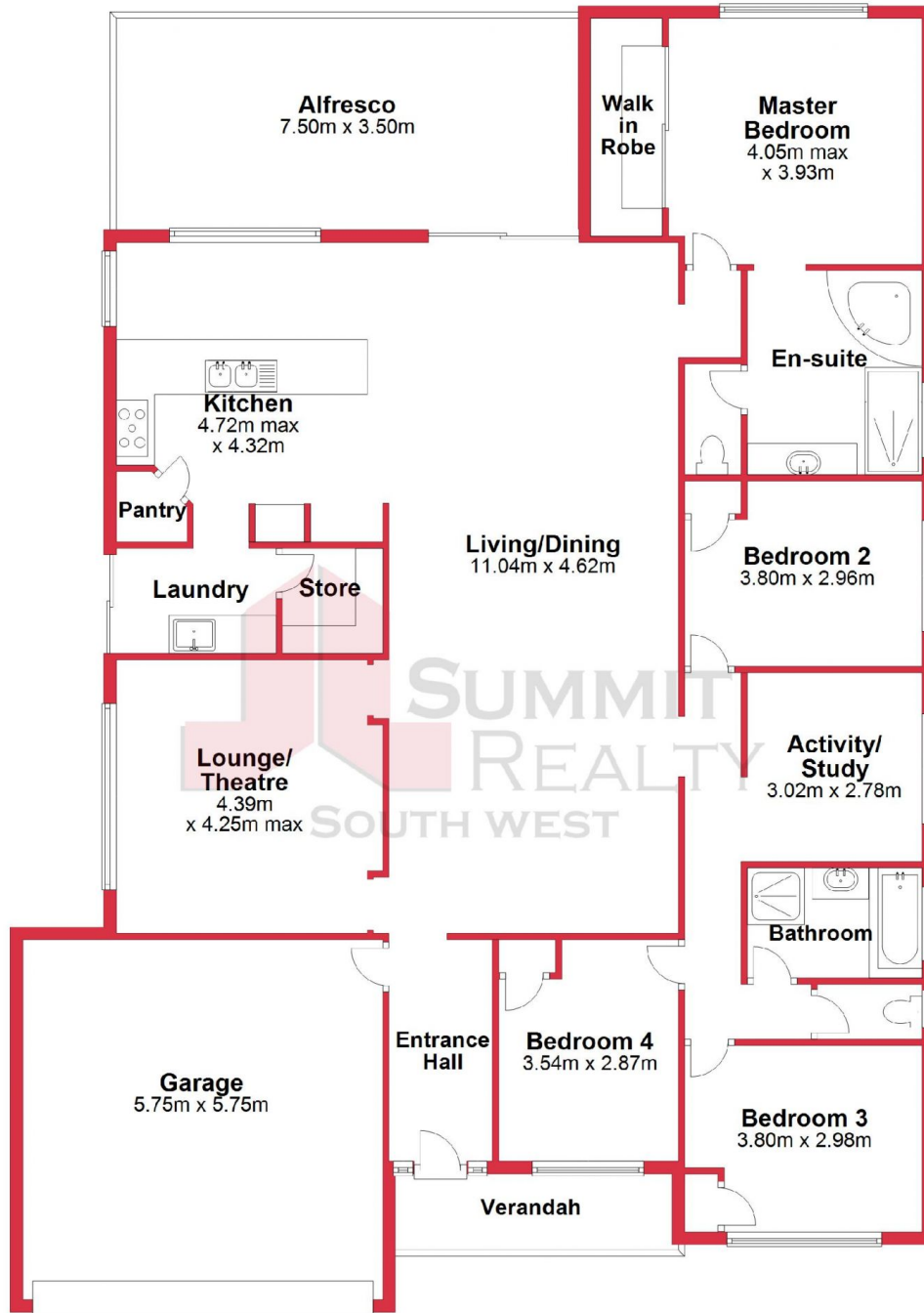

This plan has been prepared for marketing purposes only. Whilst every care is taken in the production of this plan, measurements, angles and positioning of doors/windows may not be accurate. Interested parties are strongly advised to undertake their own checks when establishing the suitability for furniture etc. Not To Scale.

Plan produced using PlanUp.

177 Maidment Pde, Dalyellup

177 Maidment Parade

Dalyellup, WA

