

31 Tourmaline Ridge Australind, WA

 4
  2
  4

A TOUCH OF CLASS

Beautifully presented inside and out, sits this classy 4 bedroom 2 bathroom home set on a large 742m2 corner block with forever views overlooking the Brunswick River. Built by Dale Alcock homes in 2011, the home offers neutral tones, quality light fittings, ceilings fans and ducted reverse air conditioning to allow for relaxed, comfortable living.

Features include:

- Generous Master suite, complete with massive WIR, ensuite with double vanity, large shower and separate toilet
- Three spacious minor bedrooms with built in robes
- Sophisticated kitchen, complete with Caesarstone bench tops, soft-close drawers, glass splashbacks, Blanco appliances and dishwasher and plenty of storage
- Fully security alarmed

For more details please visit :

<https://www.summitbunbury.com.au/6075941>

Price: \$625000

Council Rates: \$2,340.85/year (approx)

Water Rates: \$1,352.87/year (approx)



Adrian Triplett

0419 971 888

Ground Floor

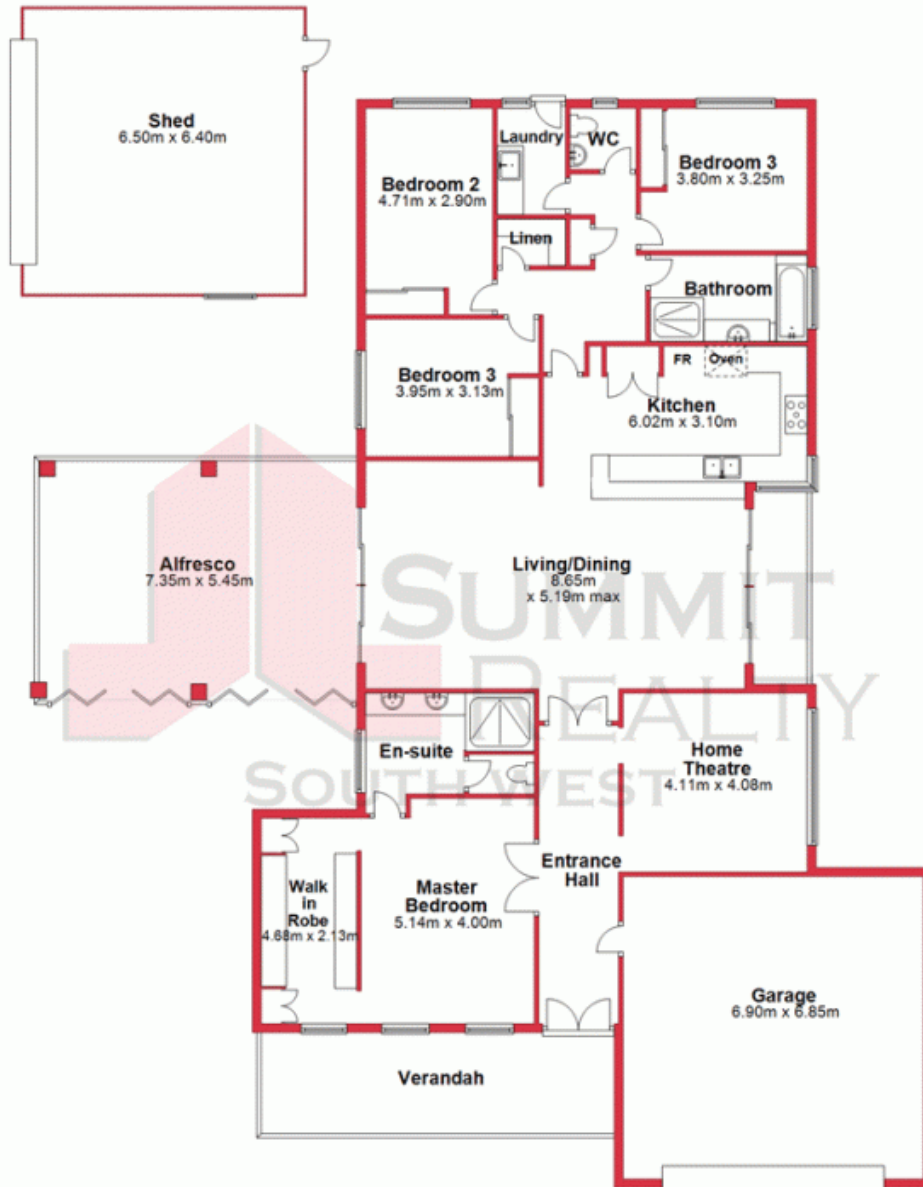

This plan has been prepared for marketing purposes only. Whilst every care is taken in the production of this plan, measurements, angles and positioning of doors/windows may not be accurate. Interested parties are strongly advised to undertake their own checks when establishing the suitability for furniture etc. Not To Scale.
Plan produced using PlanUp.

31 Tourmaline Ridge, Australind

31 Tourmaline Ridge

Australind, WA

