



1 Blaxland Road Dalyellup, WA

 3

 2

 2

GREAT ENTRY POINT TO THE MARKET!

Price: \$317500

PROPERTY FEATURES INCLUDE:

- Three well sized bedrooms all with built in robes
- Large open plan living/dining area
- Second lounge room situated to the front of the home
- Reverse cycle air conditioning to the main living area
- Quality tiled flooring throughout
- New carpets to all bedrooms and 2nd lounge
- Well-appointed kitchen with stainless steel appliances
- Double lock up carport with remote door
- Spacious rear yard, plenty of room for entertaining and very private & secure



Tim Cooper

0437 068 028

For more details please visit :

<https://www.summitbunbury.com.au/6287207>

Ground Floor

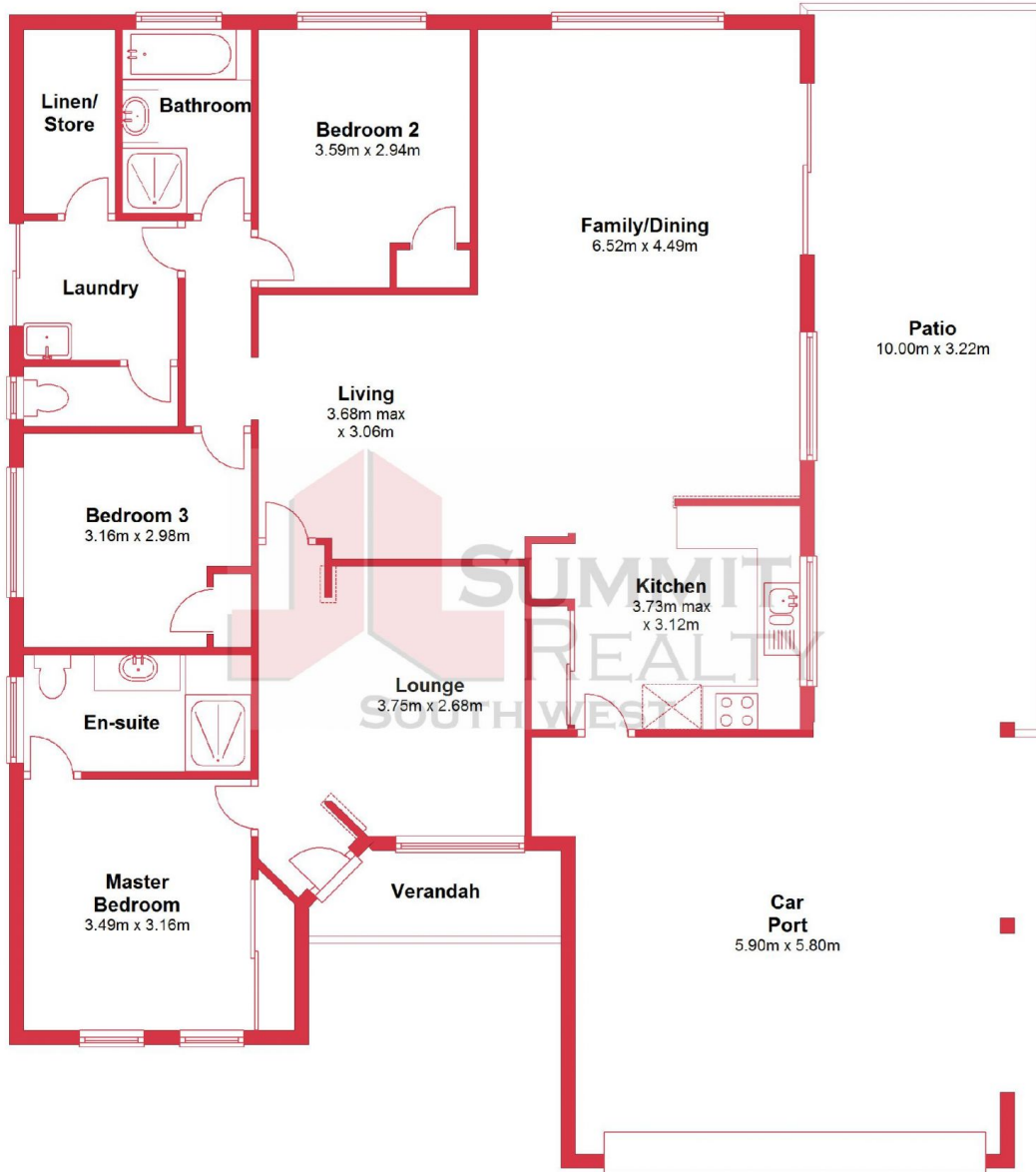

This plan has been prepared for marketing purposes only. Whilst every care is taken in the production of this plan, measurements, angles and positioning of doors/windows may not be accurate. Interested parties are strongly advised to undertake their own checks when establishing the suitability for furniture etc. Not To Scale. Plan produced using PlanUp.

1 Blaxland Road, Dalyellup

1 Blaxland Road

Dalyellup, WA

