



18 Ranson Drive Roelands, WA

 4
  2
  2

MEADOW LANDING STUNNER

Other features include:

- Four bedroom, two bathrooms
- Evaporative air-conditioning throughout
- Inbuilt cupboards in the living area
- Plantation shutters on all windows excluding wet areas
- Underfloor heating in dining and living area plus a gas bayonet
- Four TV points through out
- Extra closet / storage in the master suite
- Fully tiled in living areas, bathroom, kitchen, ensuite and laundry
- Bedrooms two and three feature walk in robes
- Stunning kitchen with dishwasher
- Extra wide entry

Price: Offers Over \$629,000

Council Rates: \$1,986.46/year (approx)

Water Rates: \$264.36 p/q



Adrian Triplett

0419 971 888

For more details please visit :

<https://www.summitbunbury.com.au/6316462>

Ground Floor

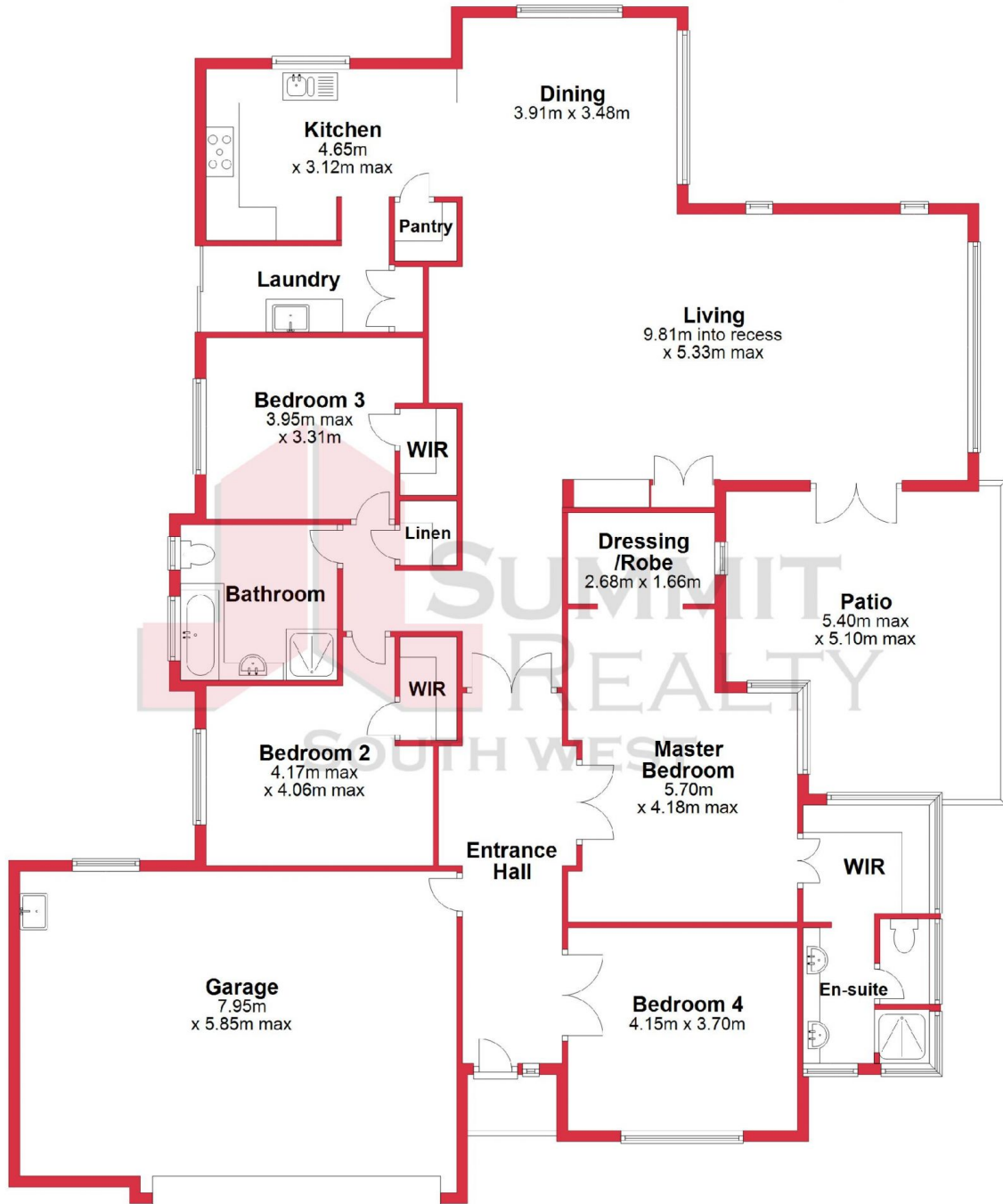

This plan has been prepared for marketing purposes only. Whilst every care is taken in the production of this plan, measurements, angles and positioning of doors/windows may not be accurate. Interested parties are strongly advised to undertake their own checks when establishing the suitability for furniture etc. Not To Scale.
Plan produced using PlanUp.

18 Ranson Drive, Meadow Landing

18 Ranson Drive

Roelands, WA

