



28 Kylie Terrace Binningup, WA



3



1



4

The Surf Shack

Located in one of Binningup's most sought after streets, with an easy walk to the beach & shop, secure this 706m2 block and either renovate or demolish and re-build in the heart of "Old Binningup". With the cottage situated at the back of the block, you can even secure a glimpse of the sea from the front deck.

Come up the stairs, step inside and you will find:

- Generous open plan living area with Jarrah floorboards, cedar venetians, air con and plenty of room for lounge and dining areas.
- An L shaped kitchen is at the other end of the living area with plenty of cupboards, room for a large fridge and an upright gas stove.
- The second bedroom also has generous proportions, jarrah floors and a skylight.
- The wet areas are towards the back of the home which provides a good option when you com

For more details please visit :

<https://www.summitbunbury.com.au/6341397>

Price: \$280000

Council Rates: \$1,472.00/year (approx)

Water Rates: \$264.00/year (approx)



Ruth Nandapi

0419 955 965

Ground Floor

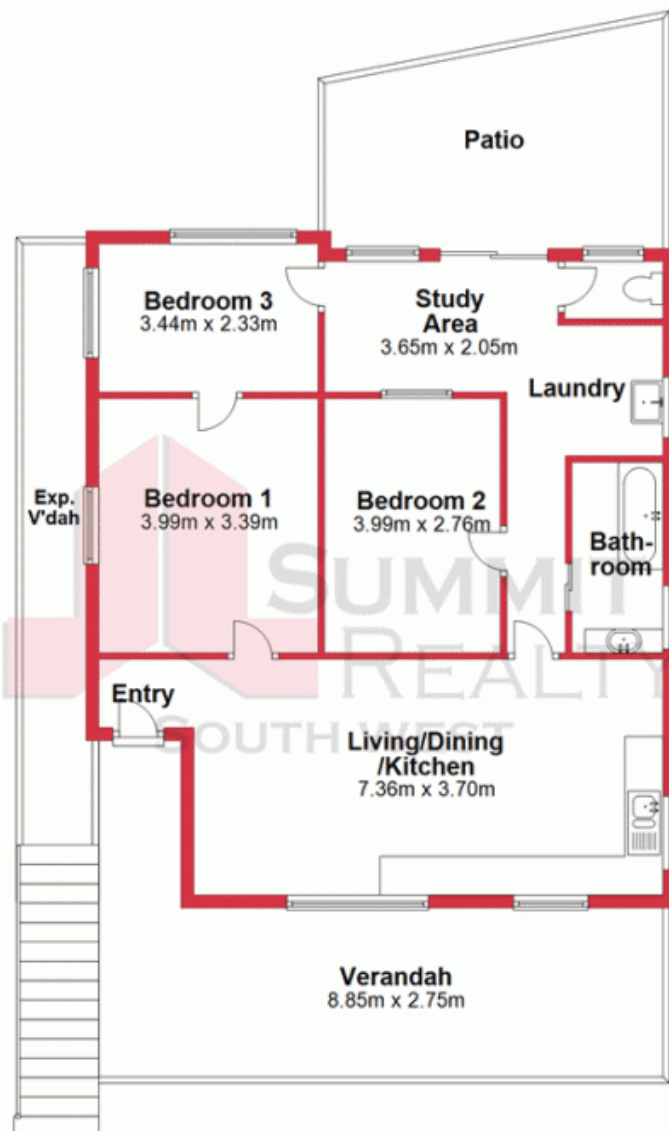

This plan has been prepared for marketing purposes only. Whilst every care is taken in the production of this plan, measurements, angles and positioning of doors/windows may not be accurate. Interested parties are strongly advised to undertake their own checks when establishing the suitability for furniture etc. Not To Scale.
Plan produced using PlanUp.

28 Kylie Terrace, Binningup

28 Kylie Terrace

Binningup, WA

