

2/17 Charolais Mews Eaton, WA

 3

 2

 2

EXQUISITE STYLE & ABSOLUTE COMFORT COMBINED

Price: \$420000

PROPERTY FEATURES INCLUDE:

- Conveniently situated at the end of a private cul-de-sac
- Low maintenance front, with garden bed and double automatic garage
- Double door entry
- Open plan living, dining and kitchen area
- Jaw dropping kitchen with breakfast bar, pantry, 900mm oven, easy clean splashback, double sinks and double fridge recess
- Separate theatre/ lounge with recessed ceilings
- Spacious master retreat with air conditioning and fan, stunning ensuite with separate bath & shower
- Practical main bathroom & laundry
- Low maintenance back lawns



Tim Cooper

0437 068 028

For more details please visit :
<https://www.summitbunbury.com.au/6347713>

- BELOW FINISHED FINISH LEVEL.
- LOCATION OF DOWN PIPES IS INDICATIVE ONLY & MAY BE CHANGED AT BUILDERS DISCRETION.
 - PROVIDE HOOP IRON HOLDING DOWN STRAPS TO AS 4055.
 - CLAY BRICKS TO ALL INTERNAL WALLS.
 - PROVIDE 9 x CORINTHIAN DECO 1 D DOORS INTERNALLY.
 - FLYSCREENS & KEYLOCKS TO ALL ALUMINIUM WINDOWS AND SLIDING DOORS.
 - R4.1 INSULATION TO FLAT CEILING AREAS OF HOUSE & GARAGE.
 - PROVIDE AIRCELL PERMACAV INSULATION TO ALL EXTERNAL CAVITY WALLS.

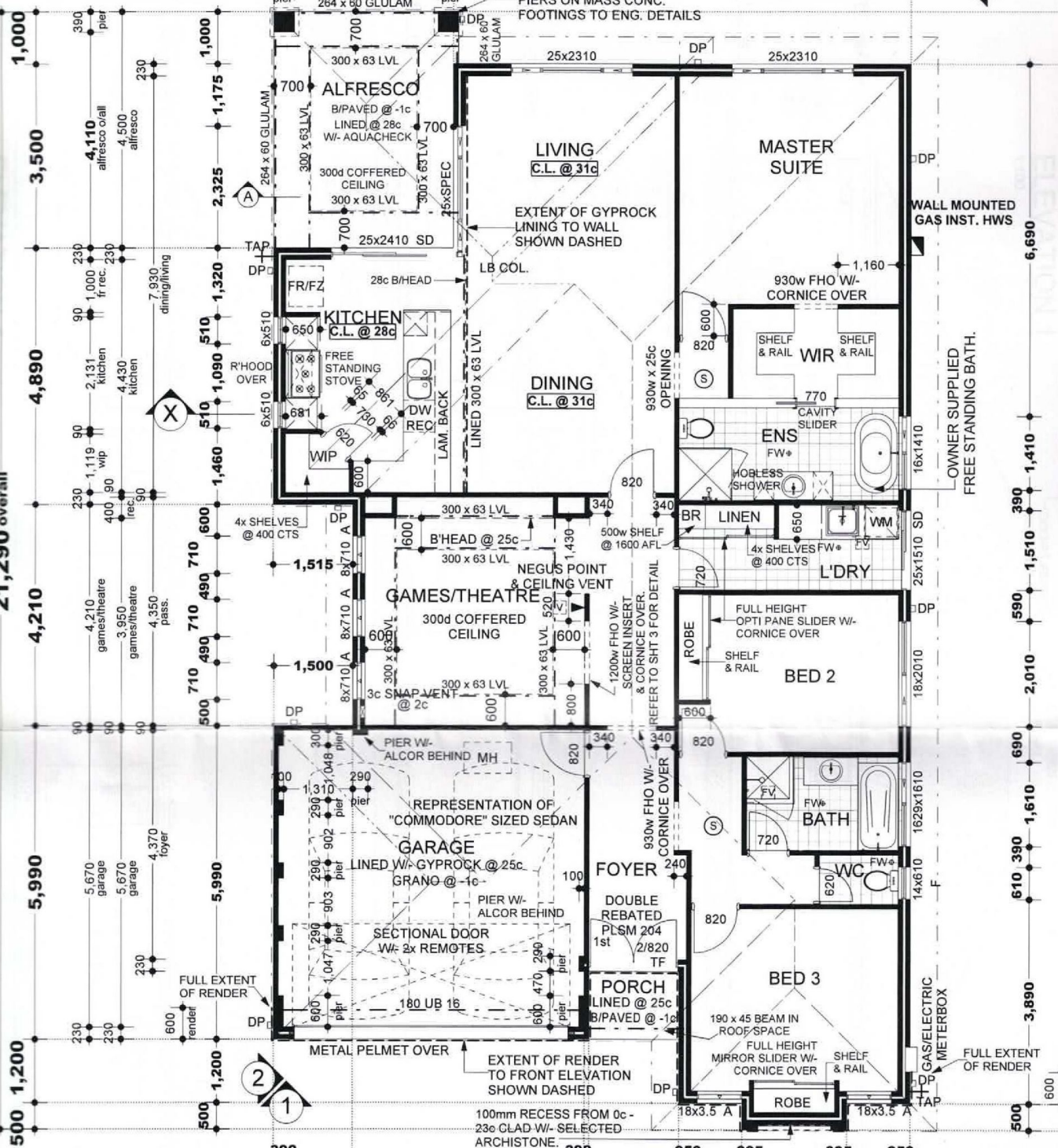

- NOTE:
- PROVIDE 7mm DIAMOND GRILL SECURITY SCREEN TO KITCHEN SLIDING DOOR.
 - PROVIDE 100mm RECESS FROM 0c - 23c CLAD W/ SELECTED ARCHISTONE.
 - METAL CORNER BEADS TO ALL EXTERNAL PLASTERED CORNERS ON INTERNAL WALLS.

- NOTE:
- OWNER BRICKL AND AG



2/17 Charolais Mews Eaton, WA

21,290 overall

WIND CLAS N1 - FOR SIN