



500 Stephen Street Bunbury, WA

HISTORIC BUNBURY BUILDING

A great opportunity to secure your very own piece of Bunbury history in this prominent corner location in the heart of the CBD.

This iconic building oozes character with its limestone construction, timber shingled roof & verandas.

Former post office, police station and bonded store, this heritage listed building is approx. 126m² & sits on 494m² of prime CBD realestate.

Plenty of usage options with zoning of "regional centre" and a recent internal refurbishment makes this a sound investment for the discerning buyer!

Price: Offers Over \$599,000

Council Rates: \$3,105.00/year (approx)

Water Rates: \$1,458.00 p/q

Strata Rates: \$0.00 p/q



Greg Gardiner

0418 932 277

For more details please visit :

<https://www.summitbunbury.com.au/6387378>

Ground Floor

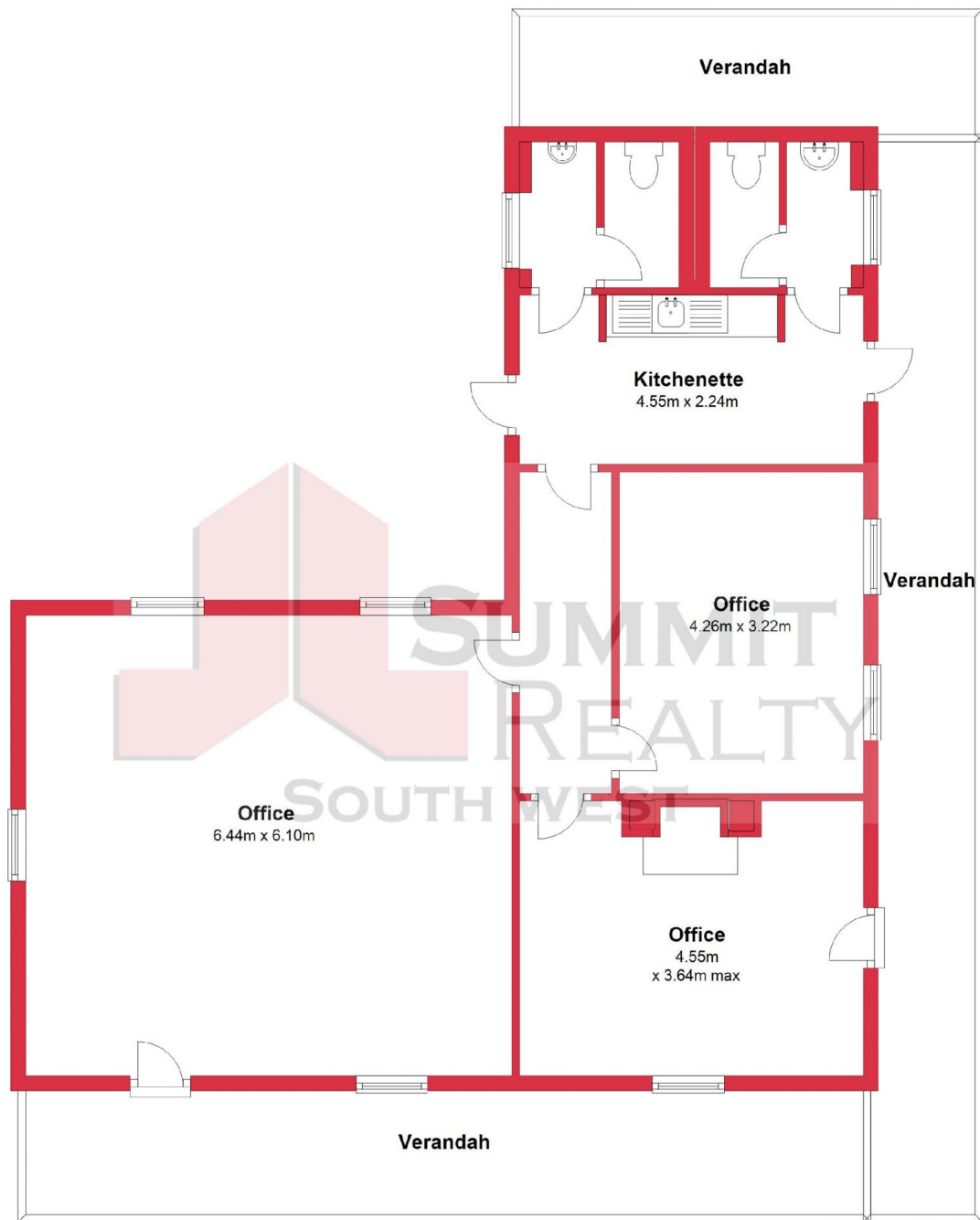

This plan has been prepared for marketing purposes only. Whilst every care is taken in the production of this plan, measurements, angles and positioning of doors/windows may not be accurate. Interested parties are strongly advised to undertake their own checks when establishing the suitability for furniture etc. Not To Scale.
Plan produced using PlanUp.

Lot 500 Stephen Street, Bunbury

500 Stephen Street

Bunbury, WA

