



1708 Mungalup Road Wellington Forest, WA

 3
  2
  4

## WELLINGTON FORREST/UPPER FERGUSON VALLEY GEM

This outstanding and very unique 20.26 HA/50 Acre property is well secluded in the heart of the Wellington Forrest off Ferguson's Pile Road, boasting many options for diversification including a current water license (9000 KL - expandable) plus three dams and a fresh water stream that runs a minimum of nine months a year (one dam stocked with Marron, Silver Perch and Trout). The property is well located within walking distance to the popular Wellington Dam.

- A double sided fan forced Jarrahdale wood fire is well placed in the heart of the living area, creating warmth for those cozy winter evenings. The master bedroom has a walk in robe with polished Marri Timber flooring and a huge ensuite with toilet, shower, big acrylic bathtub and plenty of storage. The two minor bedrooms are huge with built in robes. The main bathroom is nothing short of a Roman - Bath, it is nine square meter and

fully tiled

For more details please visit : <https://www.summitbunbury.com.au/6470848>

**Price:** \$1,295,000

**Council Rates:** \$1,632.00/year (approx)



**Lorraine Grassie**

Ground Floor

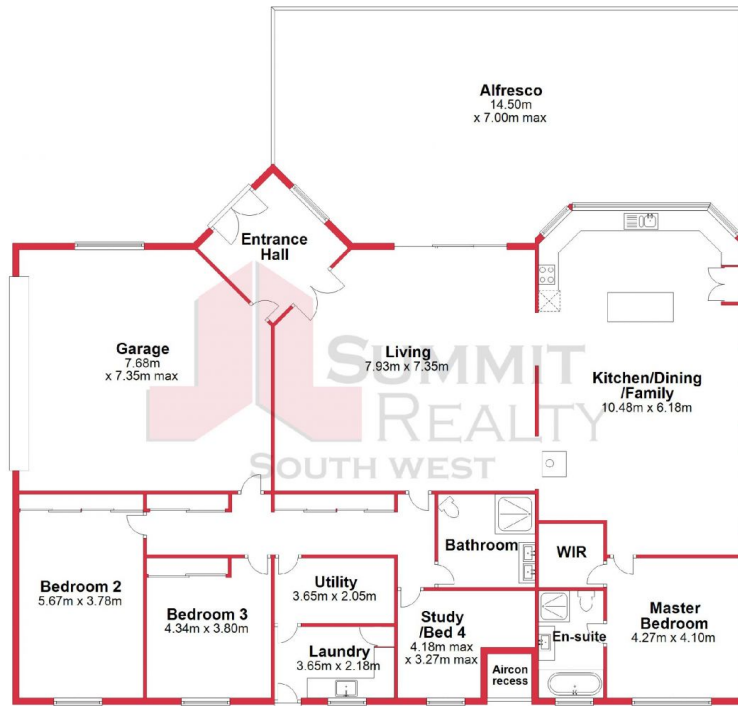

This plan has been prepared for marketing purposes only. Whilst every care is taken in the production of this plan, measurements, angles and positioning of doors/windows may not be accurate. Interested parties are strongly advised to undertake their own checks when establishing the suitability for furniture etc. Not To Scale.  
Plan produced using PlanUp.

1708 Mungalup Rd, Wellington Forrest

1708 Mungalup Road

Wellington Forest, WA

