



8 Grosmont Glade Leschenault, WA



5



2



2

UNIQUE RESORT LIFESTYLE IN LESCHENAULT

A stone's throw from the Estuary banks is this stunning, one of a kind home designed on the Busselton Bishop's historic home. Situated in a quiet cul-de-sac on a large 4004m² treed and landscaped block in a highly desirable pocket of Leschenault makes this stunning residence private and serene, the perfect Retreat.

There is a large functional floor plan with a master suite plus 4 massive double bedrooms as well as a study near the kitchen. This stunning, well-appointed country style kitchen, includes top of the range appliances - Truly a Chef's Kitchen!

Contact Adrian Triplett now.

For more details please visit :
<https://www.summitbunbury.com.au/6476319>

Price: \$865000

Council Rates: \$2,096.65/year (approx)



Adrian Triplett

0419 971 888

Ground Floor

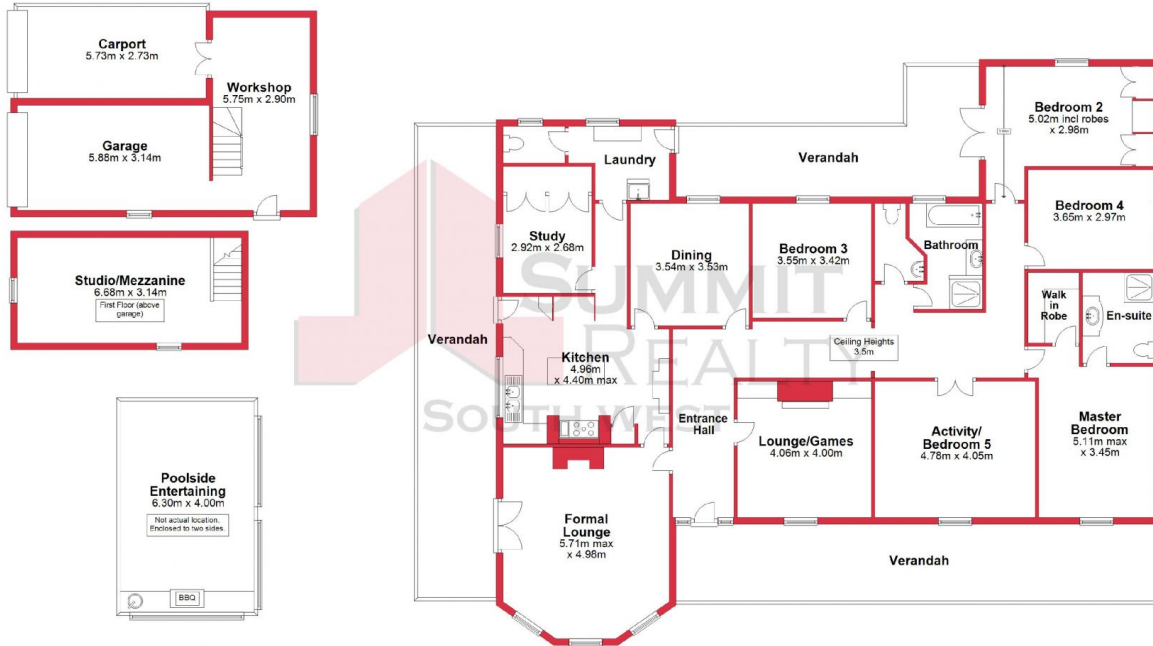

This plan has been prepared for marketing purposes only. Whilst every care is taken in the production of this plan, measurements, angles and positioning of doors/windows may not be accurate. Interested parties are strongly advised to undertake their own checks when establishing the suitability for furniture etc. Not To Scale.
Plan produced using Interplan.

8 Grosmont Glade, Leschenault