



16 Hovea Street Myalup, WA

 3
  2
  2

Space to Grow

Large blocks are hard to find in Myalup, so this flat 1,000m² block gives plenty of potential for a good sized yard, space to grow your own veges, or even have a few chickens!

The double storey home was built in 1989 and is a great size for a growing family.

Step inside the large entry and you will find:

A sunken lounge with a large bay window overlooking the front garden and timber look floors a great space for relaxing as a family. This area has a RC air con.

Walk through the large archway to the kitchen and dining area. This is a bright, sunny area with tiled floors and a sliding door leading to the back verandah. Recently renovated th

For more details please visit :
<https://www.summitbunbury.com.au/6497463>

Price: Offers Above \$420,000

Council Rates: \$1,631.00/year (approx)

Water Rates: \$275.00/year (approx)



Ruth Nandapi

0419 955 965



Ruth Nandapi

0419 955 965

Ground Floor

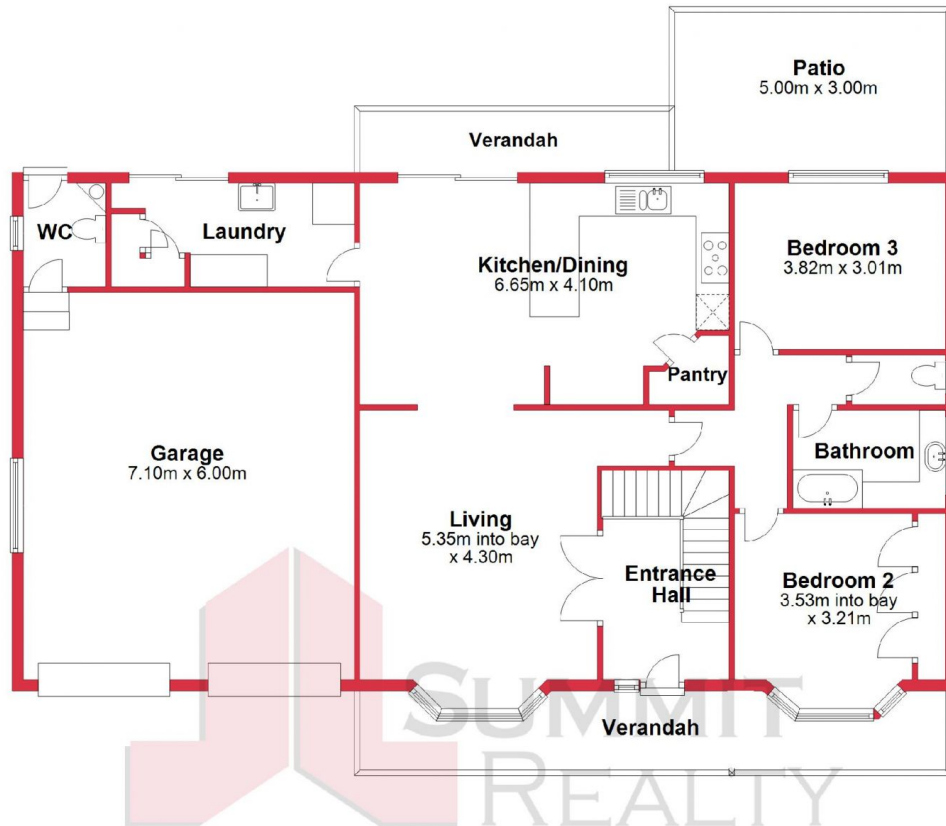

First Floor

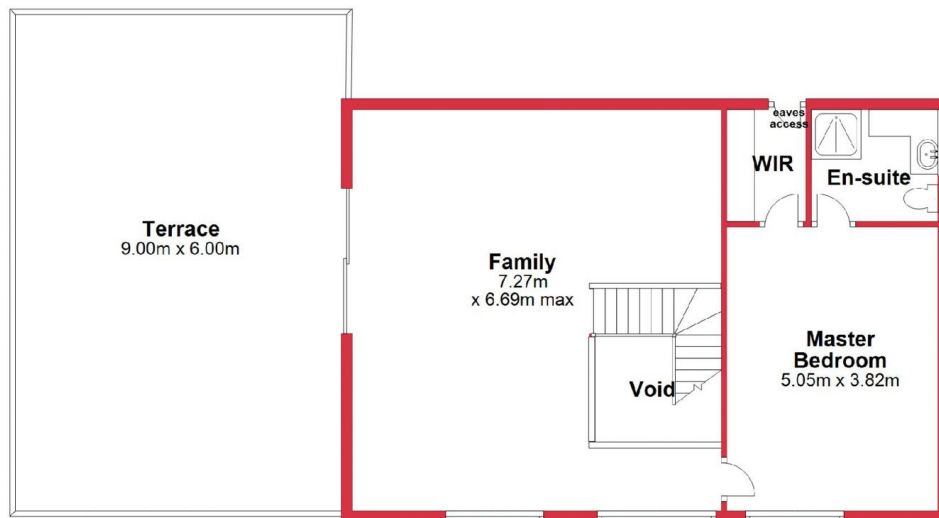

This plan has been prepared for marketing purposes only. Whilst every care is taken in the production of this plan, measurements, angles and positioning of doors/windows may not be accurate. Interested parties are strongly advised to undertake their own checks when establishing the suitability for furniture etc. Not To Scale.
Plan produced using PlanUp.

16 Hovea St, Myalup

16 Hovea Street

Myalup, WA

