



14 Neslite Road Dalyellup, WA

5 2 3

SUPERSIZED FAMILY HOME PERFECTLY LOCATED

Loaded with bonuses this home really is something completely different.

Carefully planned and adjusted for family living by the owners, this Dale Alcock built property is full of light.

The reflective porcelain tiles combined with higher ceilings magnify the feeling of space.

Opening directly onto Neslite Park this home has all the garden benefits and playground without the maintenance.

Price: Offers Over \$485,000

Council Rates: \$2,247.00/year (approx)

Water Rates: \$756.00/year (approx)



Lorraine Grassie

For more details please visit :
<https://www.summitbunbury.com.au/6556095>

www.summitbunbury.com.au

Ground Floor

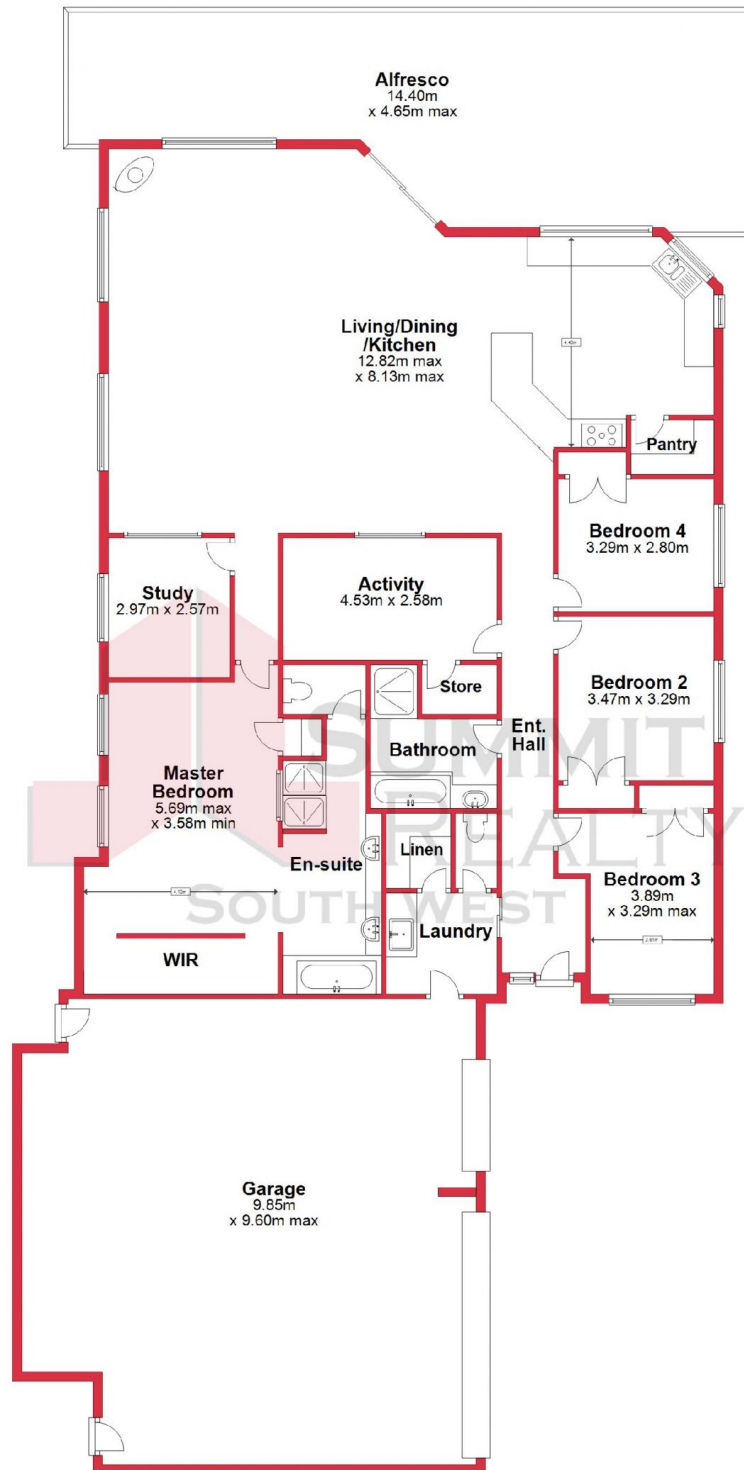

This plan has been reproduced for marketing purposes only. Plan 2 Move take no responsibility for the accuracy of stated measurements, positioning of doors/windows etc. Interested parties are strongly advised to undertake their own checks when establishing the suitability for furniture etc. Not To Scale.
Plan produced using PlanUp.

14 Neslite Rd, Dalyellup

14 Neslite Road

Dalyellup, WA

