



20 Georgia Street Binningup, WA

 4
  2
  2

## Summer Splash!

This brick and tile home enjoys an elevated position, perfect for catching the seabreeze or a glimpse of the sea!

Built in 1986, this solid brick and tile home would make a great entry level property, permanent home investment property.

Inside the front door you will find:

A wide entry with lovely timber laminate floors that look like real Jarrah, that extend throughout the home.  
The kitchen has cream cupboards & benchtops, a corner pantry, double wall oven and electric hotplate.

Outside you will find:

For more details please visit :  
<https://www.summitbunbury.com.au/6787258>

**Price:** Offers Above \$399,000

**Council Rates:** \$1,855.00/year (approx)

**Water Rates:** \$1,501.00/year (approx)



**Ruth Nandapi**

0419 955 965



**Ruth Nandapi**

0419 955 965

## Ground Floor

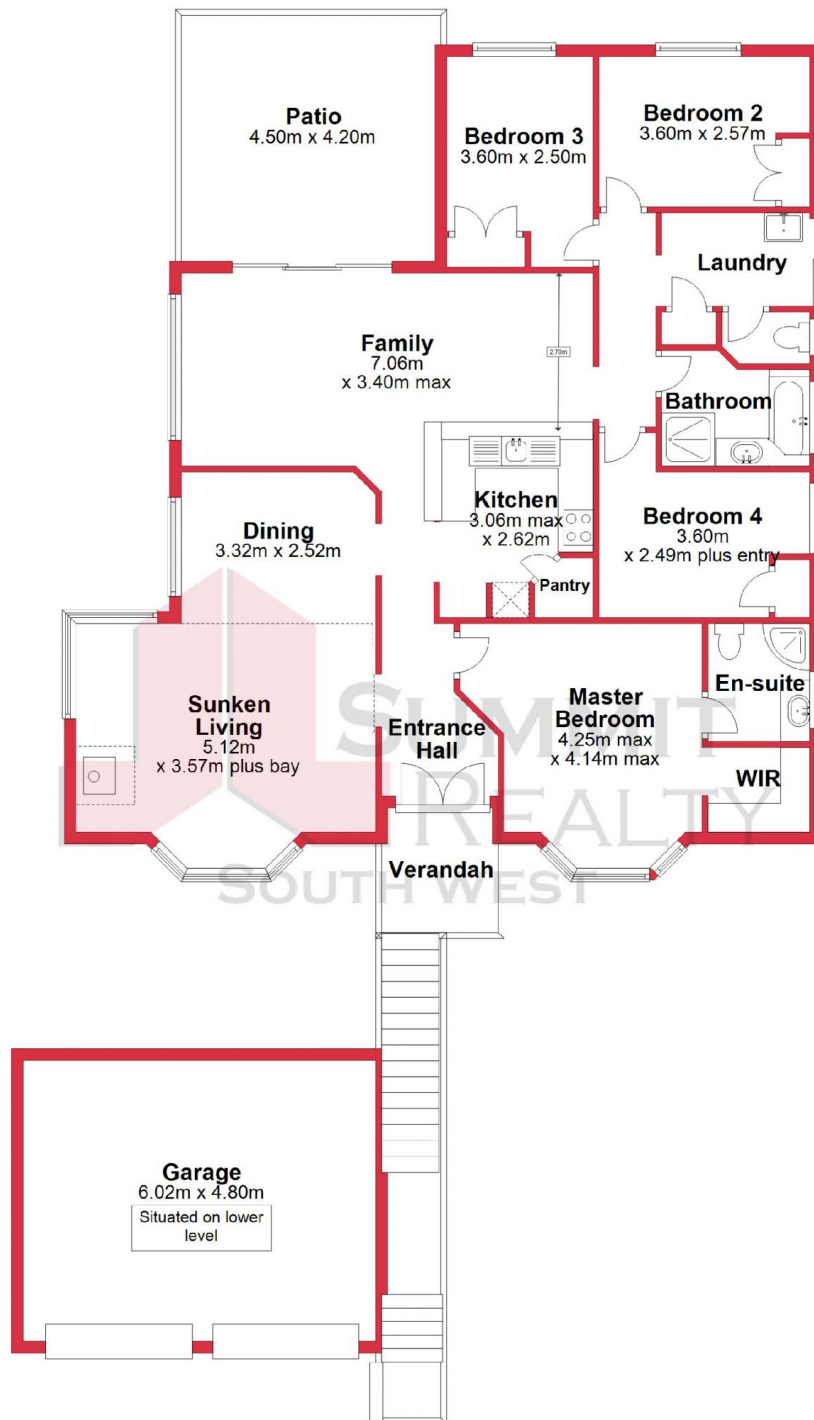

This plan has been prepared for marketing purposes only. Whilst every care is taken in the production of this plan, measurements, angles and positioning of doors/windows may not be accurate. Interested parties are strongly advised to undertake their own checks when establishing the suitability for furniture etc. Not To Scale.  
Plan produced using PlanUp.

**20 Georgia St, Binningup**

**20 Georgia Street**

**Binningup, WA**

