



20 Georgia Street Binningup, WA

 4
  2
  2

Summer Splash!

This brick and tile home enjoys an elevated position, perfect for catching the seabreeze or a glimpse of the sea!

Built in 1986, this solid brick and tile home would make a great entry level property, permanent home investment property.

Inside the front door you will find:

A wide entry with lovely timber laminate floors that look like real Jarrah, that extend throughout the home. The kitchen has cream cupboards & benchtops, a corner pantry, double wall oven and electric hotplate.

Outside you will find:

For more details please visit :
<https://www.summitbunbury.com.au/6787258>

Price: Offers Above \$399,000

Council Rates: \$1,855.00/year (approx)

Water Rates: \$1,501.00/year (approx)



Ruth Nandapi

0419 955 965



Ruth Nandapi

0419 955 965

Ground Floor

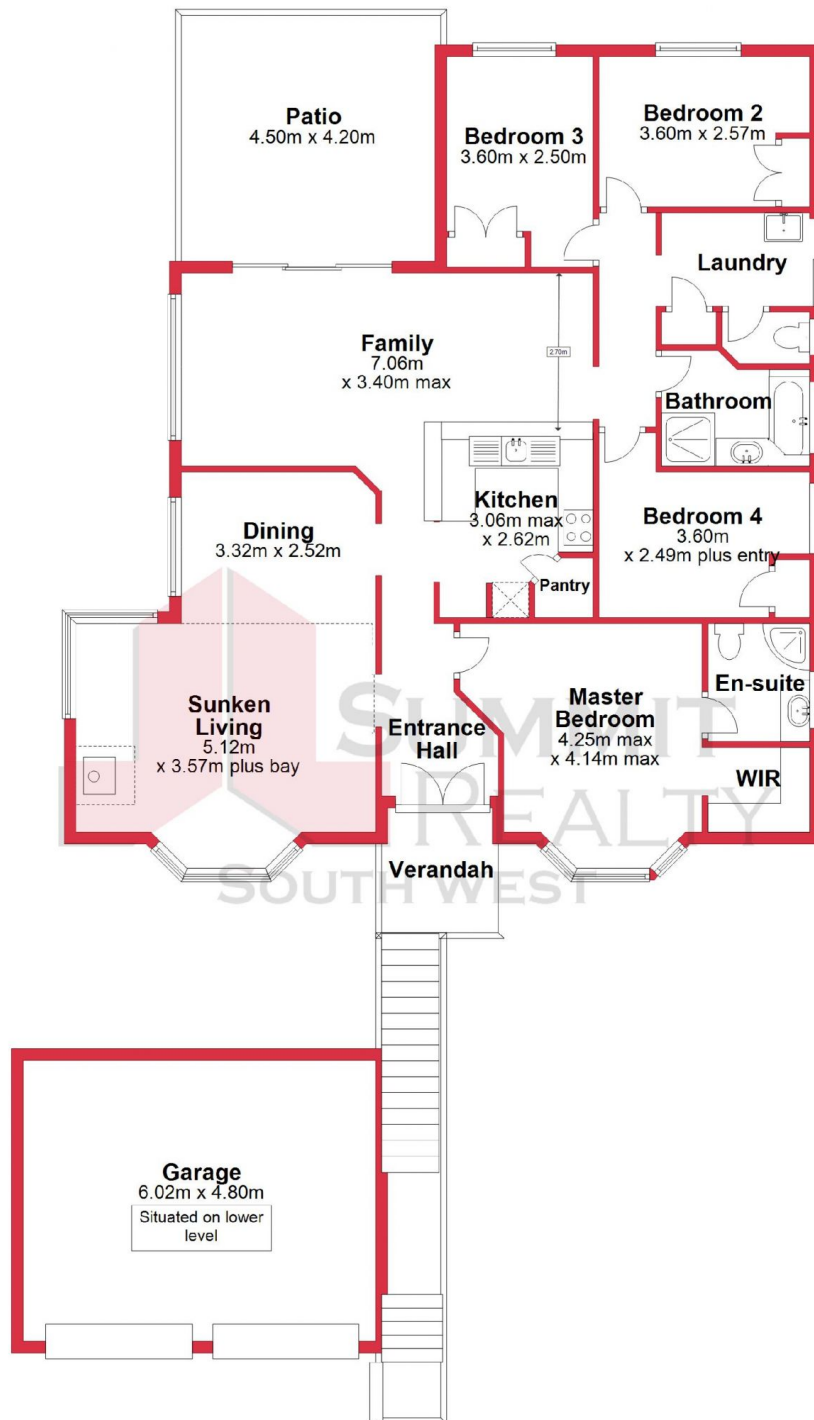

This plan has been prepared for marketing purposes only. Whilst every care is taken in the production of this plan, measurements, angles and positioning of doors/windows may not be accurate. Interested parties are strongly advised to undertake their own checks when establishing the suitability for furniture etc. Not To Scale.
Plan produced using PlanUp.

20 Georgia St, Binningup

20 Georgia Street

Binningup, WA

