



5 Tuscany Green Binningup, WA

3 Bedrooms 3 Bathrooms 1 Car

## Parkland Living

This home's sense of calm is perfectly in keeping with its parkland setting, overlooking the park in Lakewood Shores Estate.

Built in 2000, this rendered brick and colourbond home faces north, with views of the tree-lined park across the road.

Originally designed as a holiday home, the property is good for accommodating a crowd - with three large bedrooms, and three bathrooms.

Come inside and you will find:

- Large open plan living area with cathedral ceilings and plenty of natural light from the large windows at the front of the home. A cosy fireplace is a feature and there is also a reverse cycle air conditioner. Timber venetian blinds and terracotta tiles provide a touch

For more details please visit :

<https://www.summitbunbury.com.au/6916455>

**Price:** \$380000

**Council Rates:** \$1,863.00/year (approx)

**Water Rates:** \$1,488.00/year (approx)



**Ruth Nandapi**

0419 955 965



**Ruth Nandapi**

0419 955 965

## Ground Floor

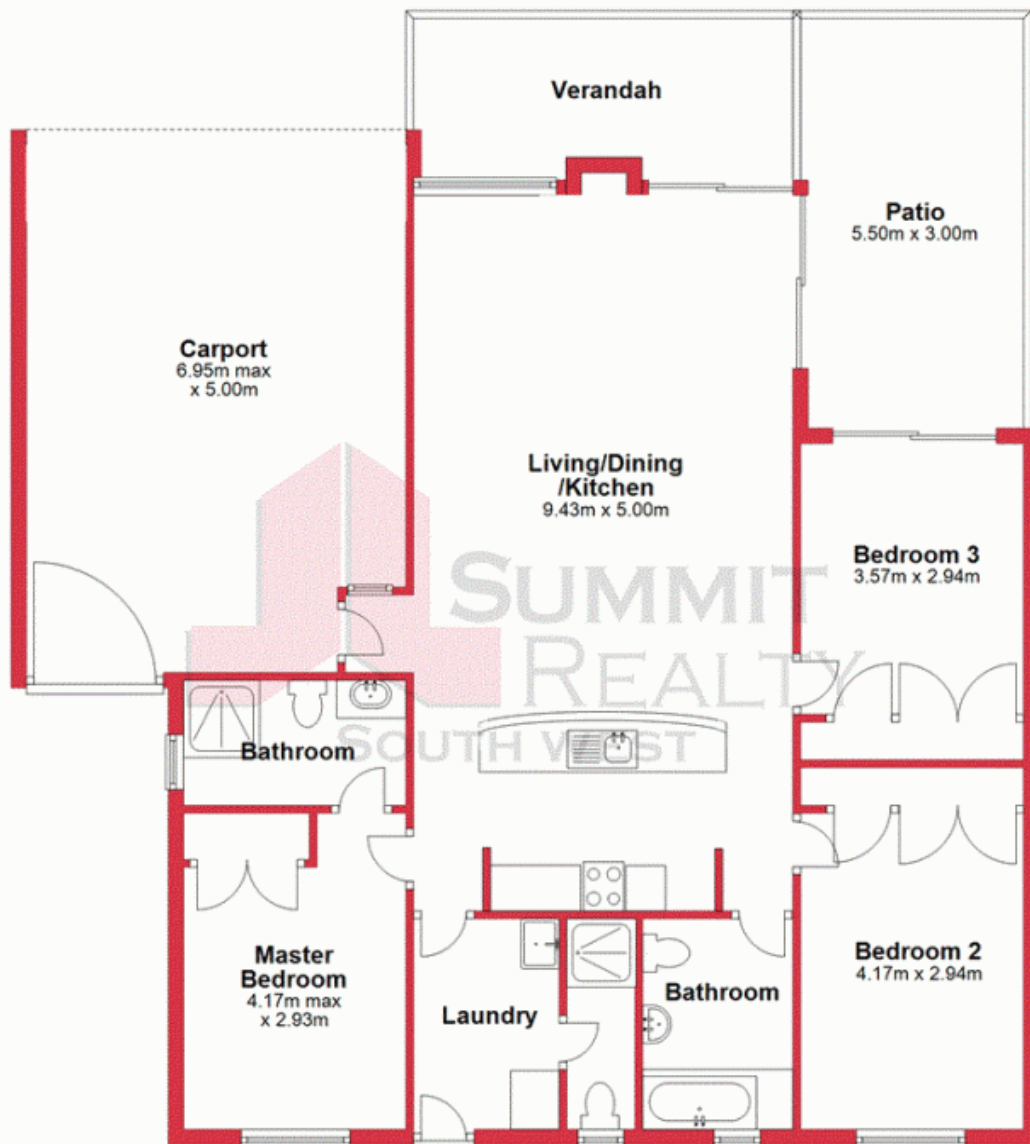

This plan has been reproduced for marketing purposes only. Plan 2 Move take no responsibility for the accuracy of stated measurements, positioning of doors/windows etc. Interested parties are strongly advised to undertake their own checks when establishing the suitability for furniture etc. Not To Scale.  
Plan produced using PlanUp.

**5 Tuscany Green, Binningup**

**5 Tuscany Green**

**Binningup, WA**

