



4 Seville Place Binningup, WA

 4
  2
  2

Great Family Entertainer

This delightful location is sure to impress those looking for a modern home on a flat block, close to the Country Club and with easy access onto the myriad of walk paths around the town. With an outlook at the rear across to a bank of Peppy trees, you will feel like you are on holiday every day.

Inside you will find:-

- Wide entry foyer finished with timber-look tiles.
- Master suite at the front of the home with downlights, block-out blind, a large tiled walk-in robe, and a modern ensuite with fully screened shower, large vanity & separate toilet.
- Open planned living with a lovely galley-style kitchen, and a dining and living area which overlooks the back yard and the peppy trees across the road. The kitchen has an appliance cupboard, stainless steel rangehood, dishwasher and a large, wide benchtop that could be used as a breakfast bar. The fridge and walk-in pantry are conveniently tucked around th

For more details please visit :

<https://www.summitbunbury.com.au/7132244>

Price: Offers Above \$509,000

Council Rates: \$2,071.00/year (approx)

Water Rates: \$1,556.00/year (approx)



Ruth Nandapi

0419 955 965



Ruth Nandapi

0419 955 965

Ground Floor

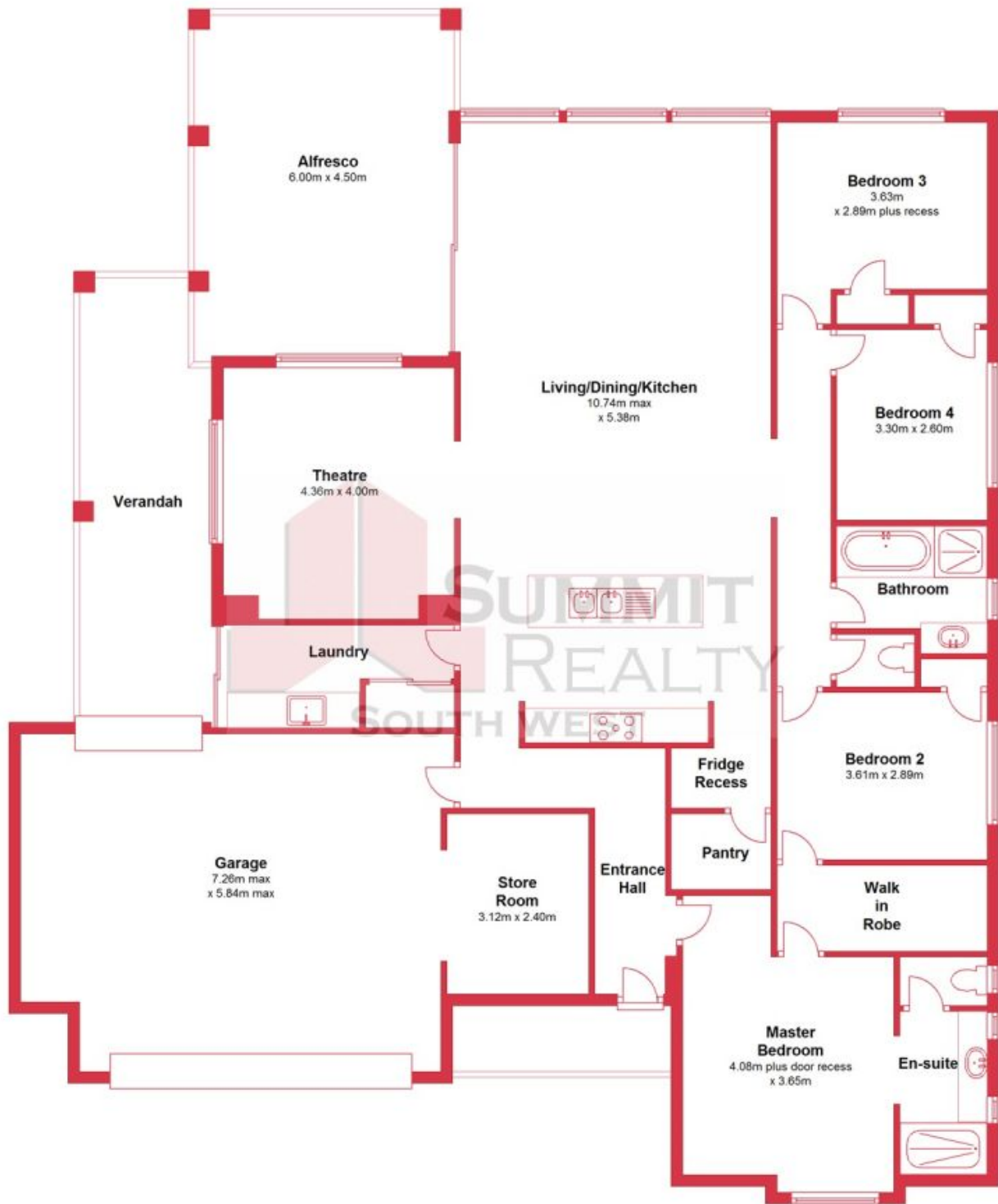

This plan has been prepared for marketing purposes only. Whilst every care is taken in the production of this plan, measurements, angles and positioning of doors/windows may not be accurate. Interested parties are strongly advised to undertake their own checks when establishing the suitability for furnishing. Plan produced using PlanUp.

4 Seville Place

4 Seville Place, Binningup
Binningup, WA

