



2/18 Bonnefoi Boulevard Bunbury, WA



3



2



2

MODERN CITY APARTMENT

Set across 3 levels, this unique floor plan has ample space to accommodate a full-time family, a holiday home or even an investment property. The apartment boasts simplistic living with its renovated chefs kitchen, open plan living and dining area and first floor terrace. Features such as the new wood look flooring and panelled barn doors bringing a fresh, modern touch to the residence.

If you are looking for a property that provides an easy relaxed lifestyle, convenient to all amenities and easy to maintain, then this is the property for you!

GROUND FLOOR

- Small courtyard streetside entry
- Large bedroom with walk-in robe or secluded office/loungeroom
- Two secure parking bays

FIRST FLOOR

Price: Offers Over \$525,000

Council Rates: \$2,456.31/year (approx)

Water Rates: \$1,219.76/year (approx)

Strata Rates: \$4,345.20/year (approx)



Adrian Triplett

0419 971 888

For more details please visit :

<https://www.summitbunbury.com.au/7229241>

First Floor

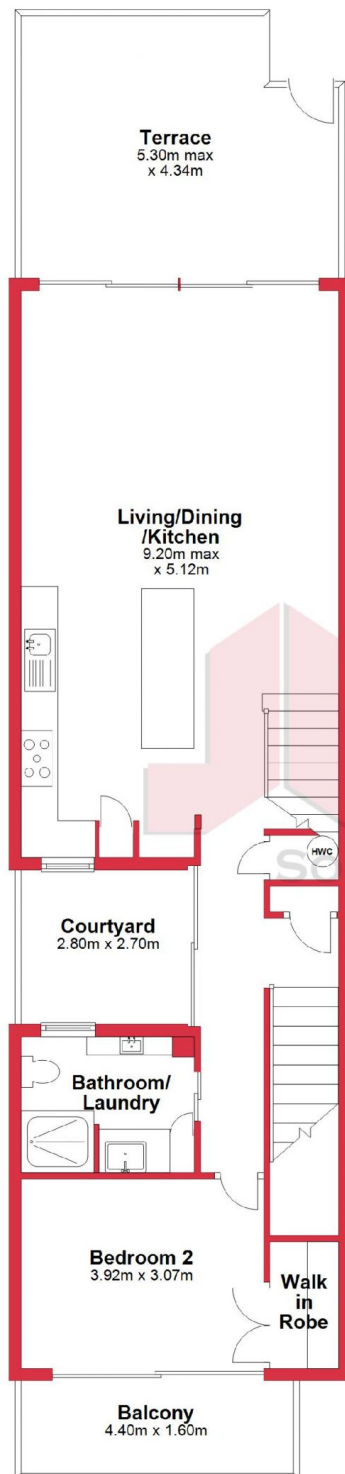

Ground Floor

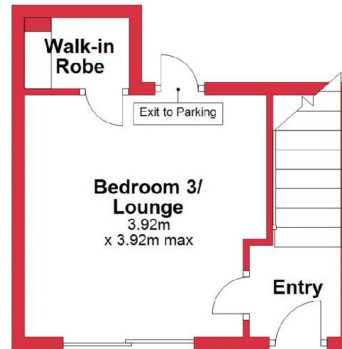

Second Floor

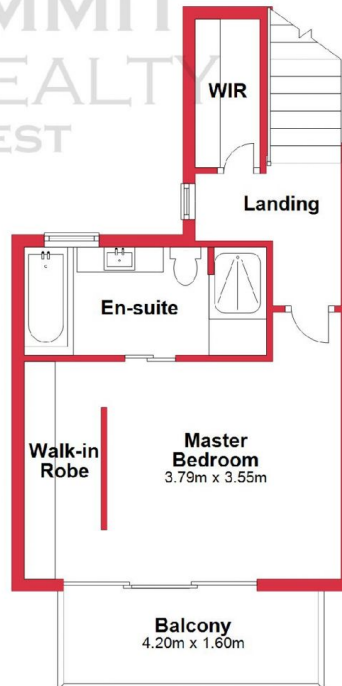

This plan has been prepared for marketing purposes only. Whilst every care is taken in the production of this plan, measurements, angles and positioning of doors/windows may not be accurate. Interested parties are strongly advised to undertake their own checks when establishing the suitability for furniture etc. Not To Scale.
Plan produced using PlanUp.

2/18 Bonnefoi Blvd, Bunbury

2/18 Bonnefoi Boulevard

Bunbury, WA

