



15 Absolon Crescent Australind, WA

 4
  2
  1

BY THE WATER

This charming family residence is nestled in the beautiful suburb of Australind, just footsteps from the Leschenault Estuary, parks, schools and shopping centers. Manicured gardens and a private tea garden greet you at the main entrance of the home whilst the side access leads your through to the workshop and well-kept green gardens. Inside, as well as the bedrooms, you'll find both a sunken lounge room and separate sitting area with wood fire, dining room and a spacious kitchen.

If you are looking for a generous family home at a reasonable price that you can add your own touches to, then this home is a must see!

FEATURES

- Sunken front loungeroom with water views
- Practical kitchen with ample storage space, dining room off kitchen
- Living room with wood fire and split system air-conditioning
- Reticulated gardens with bore water access

For more details please visit :
<https://www.summitbunbury.com.au/7418986>

Price: Offers Over \$575,000

Council Rates: \$1,891.42/year (approx)

Water Rates: \$1,106.20/year (approx)



Adrian Triplett

0419 971 888

Ground Floor

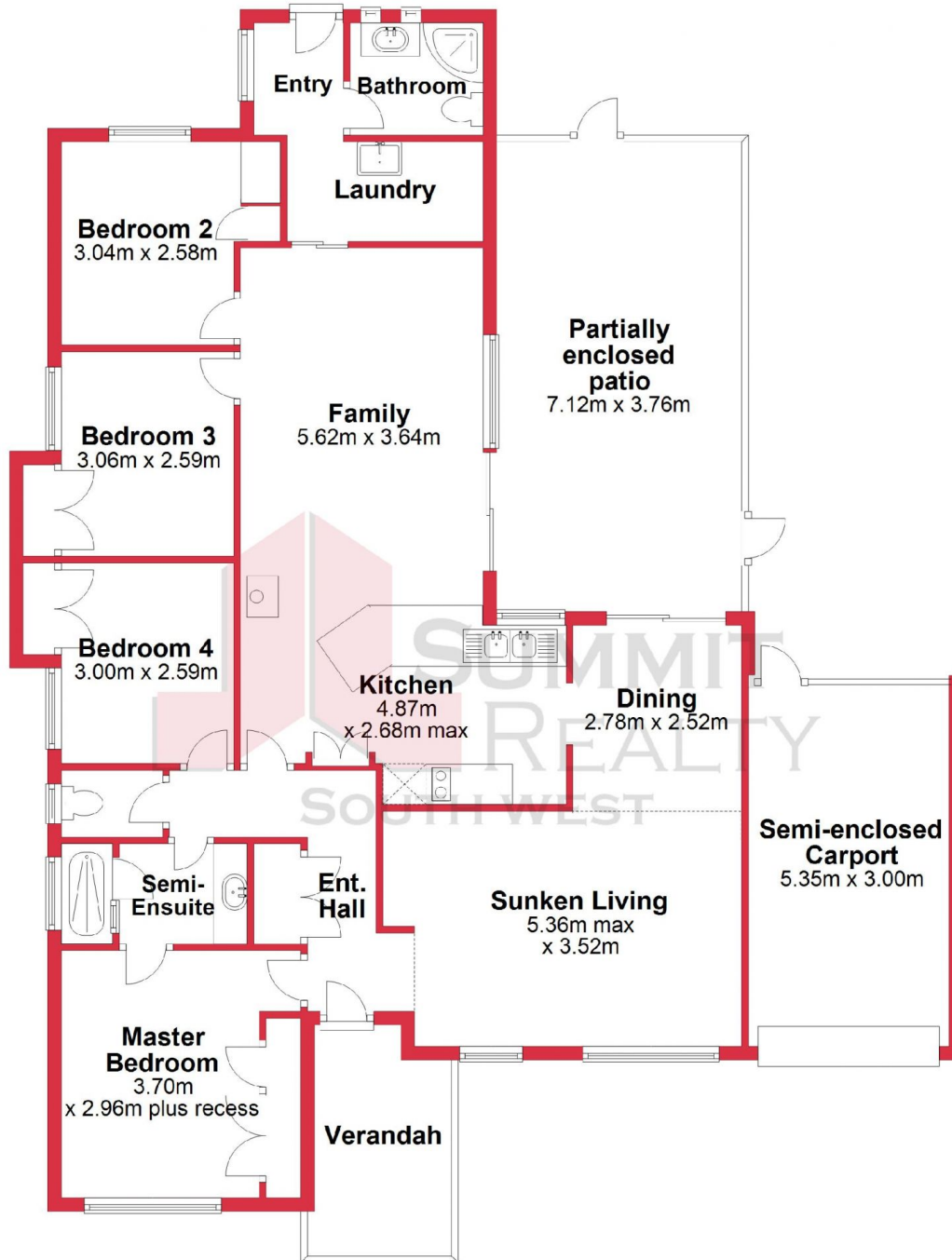

This plan has been prepared for marketing purposes only. Whilst every care is taken in the production of this plan, measurements, angles and positioning of doors/windows may not be accurate. Interested parties are strongly advised to undertake their own checks when establishing the suitability for furniture etc. Not To Scale.

Plan produced using PlanUp.

15 Absolon Crescent, Australind

15 Absolon Crescent

Australind, WA

