



48 Mindalong Close South Bunbury, WA

 4
  2
  2

SOLD BY TIM COOPER!

Indulge in coastal elegance at 48 Mindalong Close, beyond the impeccable street appeal you'll step inside and discover a beautifully presented family residence where spacious living seamlessly blends with meticulous design, creating an inviting and warm atmosphere that resonates in both comfort and sophistication.

Surrounded by well-maintained homes in an outstanding location just seconds to the beach, this stunning 4 bedroom home is set on a generous size 970sqm block and presents an fantastic opportunity for Buyers searching for their forever home!

Lovingly cared for both inside and out, the home showcases an impressive list of features and perfectly caters to the growing family. Highlights include high ceilings and feature lighting throughout, multiple spacious living areas including large sunken front lounge room with recessed ceilings and formal dining, large home office with built-in cabinetry, so

For more details please visit :
<https://www.summitbunbury.com.au/7953476>

Price: \$885000

Council Rates: \$3,149.33/year (approx)

Water Rates: \$1,250.27/year (approx)



Tim Cooper

0437 068 028

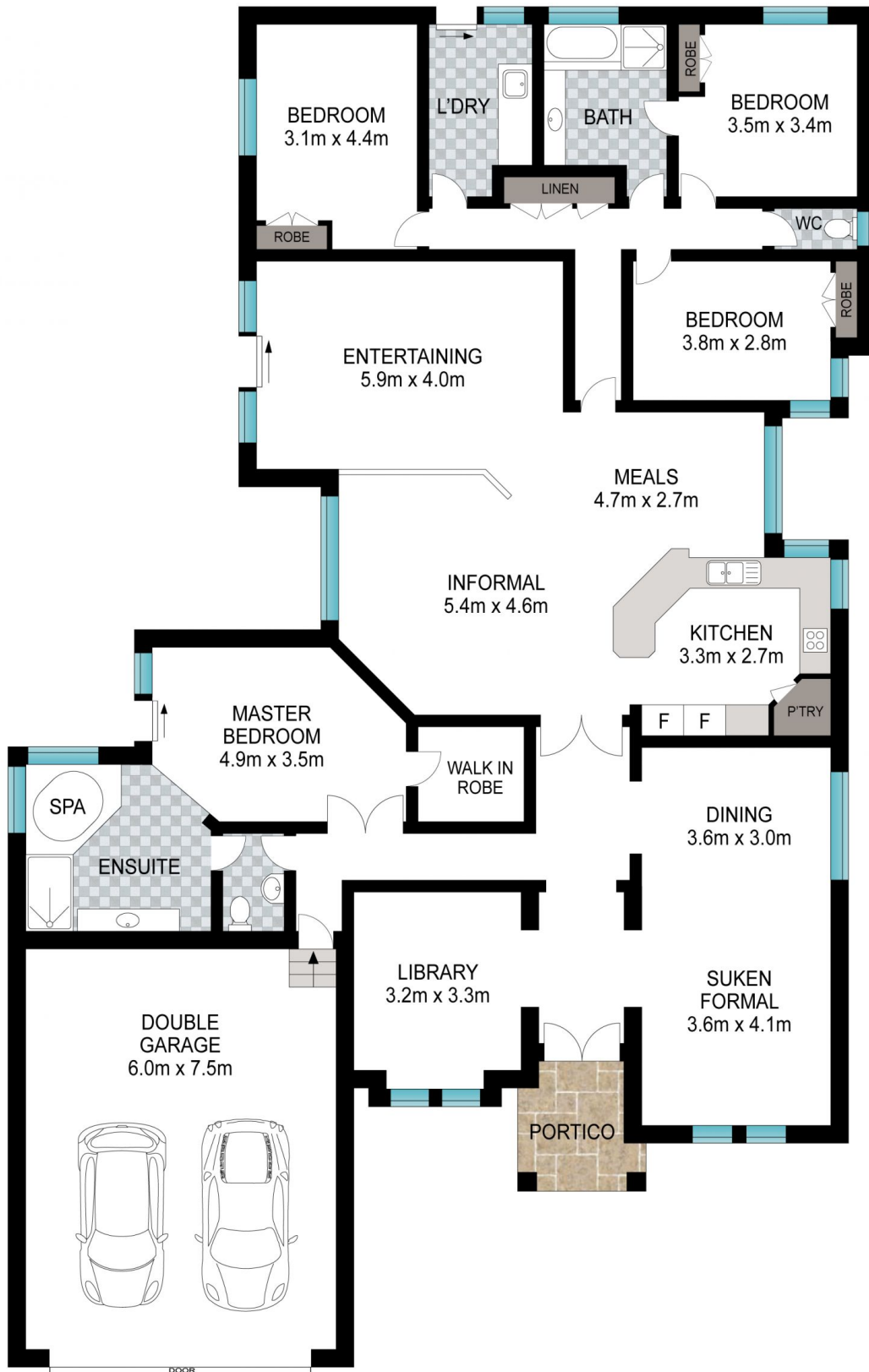

48 Mindalong Close

South Bunbury, WA

