



105 Leschenault Parade Australind WA

4  2  2 

Enjoy family living in this lovely home in the sought after Galway Green Estate.

With its elegant street presence you will be immediately drawn to the federation style façade, neat hedging and the substantial home that lies within.

Built in 2002 this home has plenty of room for a growing family and a versatile floorplan to accommodate your needs.

Step into the entry and you will find:
 ? Tassie oak flooring which extends through the living area of the home and extra high ceilings.
 ? Formal lounge at the front of the home with built in

Type : House
Building Size : 219 sqm
Land Size : 742 sqm
View : <https://www.summitbunbury.com.au/8196938>



Ruth Nandapi
08 9780 0515

[For full version visit the website](https://www.summitbunbury.com.au)

Ground Floor

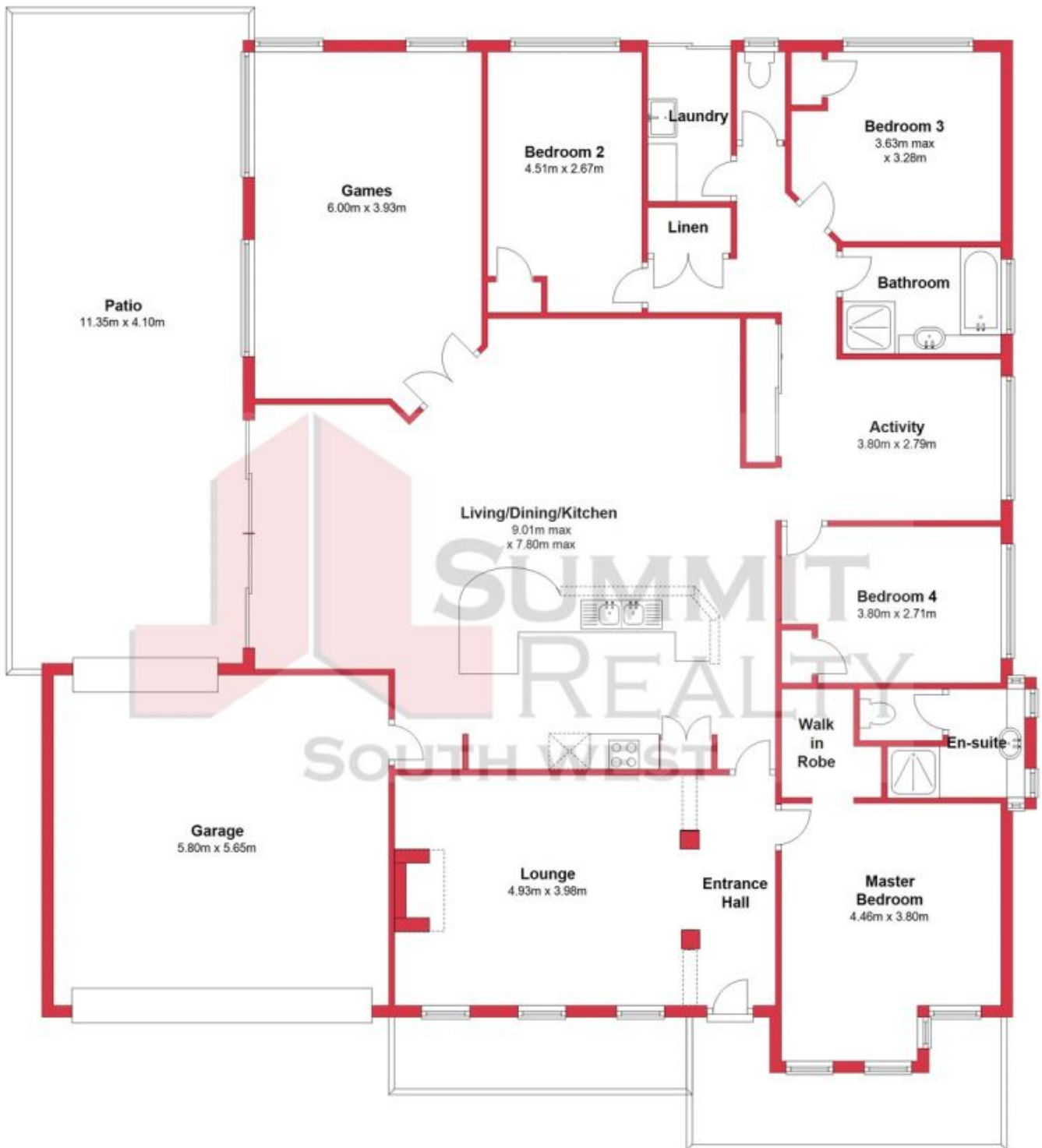

This plan has been prepared for marketing purposes only. Whilst every care is taken in the production of this plan, measurements, angles and positioning of doors/windows may not be accurate. Interested parties are strongly advised to undertake their own checks when establishing the suitability for furniture etc. Not To Scale.

Plan produced using PlanUp.

105 Leschenault Drive, Australind